

## Old Huntington Cemetery - "Old Burying Ground"

as provided by Roberet C. Hughes, Esq., Huntington Town Historian

The following file is a copy of the inventory of internments at the "Old Burial Ground in Huntington." The inventory was begun in 1895 and continued into the 1930s and 40s. Also included is a map of the cemetery. As you will see the cemetery is divided into 5 sections. The original listing started numbering graves at 1 for each section. The enclosed list is alphabetical by section. The numbers to the left of the name refer to the original numbered lists. The following explanation of the numbering may help. "Many of the stones listed are no longer legible or extinct. Unfortunately, the burying ground has been the site of many incidents of vandalism over the years. The town is currently formulating plans for restoration of the cemetery, including transferring the list to a searchable computer database. In the meantime I hope you find this listing helpful in your research.

Huntington Rural is located on New York Avenue - NY 110 - south of Huntington Village, about 1/3 of the way towards the LIRR depot, which is current Huntington Station. Today, the rural cemetery extends over the hill and backs up on Oakwood Road.

---

This list of grave stones in the "Old Burying Ground" was first compiled by Mr. Edwin Dusenberry in 1895; added to by Mrs. Reginald Runge; and this copy made by Roy E. Lott, Town Historian, in December 1956.

Many of the stones are defaced at this time, and but for the work of Mr. Dusenberry and Mrs. Runge, no record would be available, as complete as this.

No doubt some graves existed at the time of the erection of Fort Golgotha, which were obliterated by the English, and of which we have no record.

This list contains 1246 names.

p.99, Vol.III, Town Record; 100 stones destroyed, 1783.

---

### **NOTE Regarding Huntington Cemeteries:**

Old Huntington Cemetery or "Burial Ground" is on the National Register of Historic Places; it was the site of Fort Golgotha built during the last few years of the British occupation of Huntington during the Revolution ... CA. 1781/82 the fort was built, destroying many older gravestones.

The cemetery is located at the junction of Main Street - NY 25A- and Nassau Road in Huntington Village. Originally, this was the burying ground for what is now Old First Presbyterian Church. It was their second cemetery, opened about 1720 or so. The original cemetery was located near the present church building on 25A and is inside present Heckscher Park, near the corner of Main Street - NY 25A- and Spring Street. The old mill ponds of Ezra Conklin Prime's thimble factories are now duck ponds in the park.

Huntington Rural is a different place than Old Huntington. Huntington Rural was opened as a commercial cemetery in 1853. It has lots of pre-1853 burials as people [like those from the Lemuel Carll plot] were moved there from farm cemeteries. Huntington Historical has an excellent Index to the 1990s.

Sec. 1

That portion which lies on the South side (right hand) of the path leading from the Memorial Bldg. gate, to the one on Nassau Road opposite Platt Street - Numbers seen from left to right when facing stones.

Sec. 2

That which lies between the above named path, and the one leading from the small gate to the top of the hill, where they intersect. Numbers run from right to left.

Sec. 3

That portion which lies between the last named path ( from the small gate) and the one by the tool house which runs to the top of the hill, where they are joined by a short path. Numbers run from left to right.

Sec. 4

Bounded by the path from the tool house gate which continues to the path which leads from the Memorial Bldg. to Nassau Road. Numbers run from left to right.

Sec. 5

That portion on top of the hill which is circumscribed by the above named paths. Numbers from left to right.

Last disposition 1944

① The dimensions in the Huntington Record of old grave inscriptions are in accordance with the section numbers shown on this map.

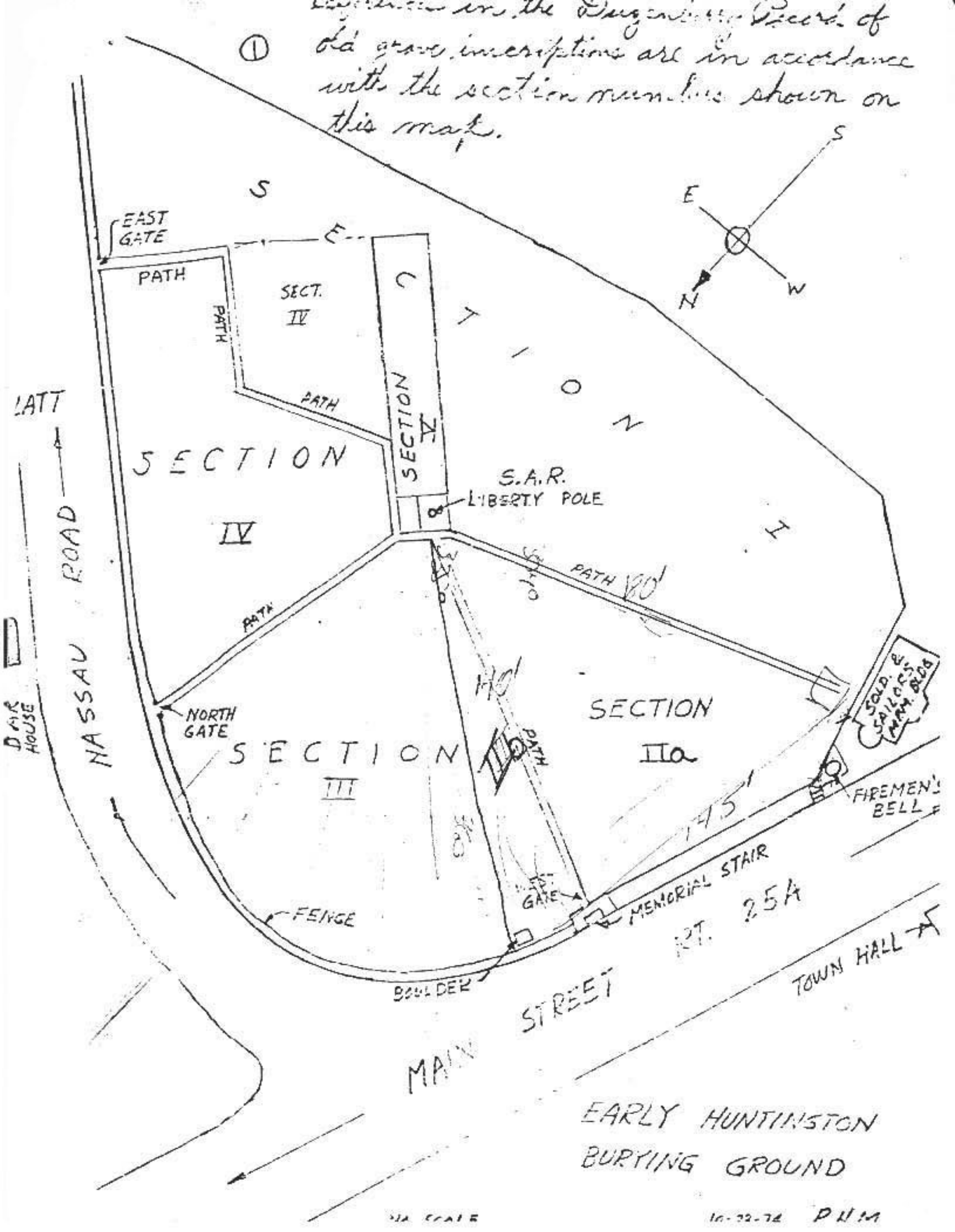

EARLY HUNTINGTON  
BURYING GROUND

1/2" SCALE

10-22-72 P.H.M.



- 43, Bartow Jane, wife of Thomas J. -- d. 6/16/1834 52 yrs. 7 mo.  
 I30, Bennett Sarah, wife of Titus.--- d. 8/11/1831 87  
 I30, " Titus, d. at Charleston S. C. 1790 46  
 I31, " Daniel, d. 4/17/1858 81 7  
 I32, Boyce hannah wife of David Boyce dau. of Zephania Rogers 11/21/1829  
 22 yrs. 1 mo  
 I33, " Jacob P., son of above, d. 5/23/1846 16 yrs. 6 mo. 12 da.  
 I34, " Horatio Nelson, son, d. 10/27/1828 ae. 10 mo.  
 I96, Belknap Hannah Williams, wife of Abel, d. 5/19/1784 ae. 31yrs. 6mo.  
 240 Bouton Samuel, d. 3/29/1862 70 yrs.  
 241, " Ruth, wife of Benajah d. 6/12/1844 79 yrs.  
 242, " Benajah, d. 10/2/1838 ae. 78  
 243, " " Jr. d. 6/23/1839 ae. 34  
 244, " Richard M., 5/25/1788-- 12/13/1848  
 245, " James, d. 2/24/1857 ae. 56  
 246, " James A., son of Amos & Sarah, 3/13/1859 ae. 2 yrs. 27 da.  
 247, " Emma Eliza, daughter " 10/28/1863 ae. 1 yr. 2 mo. 23 da.  
 248, " Benajah Francis, son, Amos & Elenor, 1/30/1834, ae. 3yr. 10 mo. 26 da.  
 249, " Amos, 9/17/1790-- 4/18/1849  
 249, " Elenor, w. of Amos, 9/4/1796-- 9/2/1881  
 I35 Brush Hannah, w. of John D., d. 10/20/1829 ae. 40  
 I36, " John D. d. 12/19/1830 ae 40  
 I37, " Hannah, dau. Edward & Cornelia, d. 9/12/1842 ae. 27yr. 8 mo.  
 I38, " Cornelia, w. Edward, dau. Isaac Conklin, d. 1/31/1855 ae. 38  
 207, " Hannah Johnson, w. of Nathaniel G., d. 2/21/1875. ae. 71  
 208, " Nathaniel G., d. 10/9/1870  
 209, " Amelia, dau. Nath. G. & Jane A., d. 5/8/1855 ae. 32yr. 1mo. 16da.  
 279, " Zophar, son Jacob & Sarah, d. 6/4/1753, ae. 2 yr.  
 280, " Jacob, d. 10/17/1731 ae. 43 yr.  
 281, " Mary, w. of Jacob, d. 11/1/1761 ae. 67  
 299, " Frances Arabella, dau. Geo. & Amanda, d. 11/1/1842 ae. 2-1-14  
 308 Brown Rev. Nehemiah, d. 1/5/1876, ae. 85  
 309, " Henrietta, wife of above, d. 4/21/1850 ae. 43-2-24  
 310, " Conklin Waldo, s. of above, d. 5/20/1846, ae. 6-9-18  
 311, " Abel K. son, d. 10/2/1846, ae. 1yr. 10 da.  
 314, " Henrietta, dau. d. 3/23/1831 ae. 16 mo. 25 da.  
 315, " Elizabeth, dau. d. 3/30/1837, ae. 2yr. 11mo.  
 339 BRUSH Van Rensselaer, son of Issac & Deborah d. 10/22/1863, ae. 22-5-13  
 400 Bennett Rebecca, w. of Jacob, d. 8/20/1854, ae 68-10-5  
 401, " Jacob, d. 3/3/1859, ae 77-9-23  
 480 Betts Lucretia, dau. Burril & Amelia, d. 12/12/1835, ae 1yr. 7Mo.  
 I26 Burr Daniel, son wm. & Sarah, d. 2/1/1845, ae. 4-5-12  
 265 Bumpstead Elizabeth, w. of Thomas, d. 8/26/1827 ae. 26  
 266, " Ruth, dau. Thomas & Ruth, d. 10/5/1855, ae. 22-6-3  
 267, " Thomas, d. 12/17/1859, ae. 65yr. 20 da.

- 286, Buckley Wm. s. Wm. & Lavinia, d. 11/7/1841 ae. 4mo. 9 da.  
 289, " Burr, d. 10/2/1828 ae. 51-2-8  
 290, " Sarah w. of Burr, d. 2/17/1867, ae. 83-10-20  
 464, Burtis Ruth, w. of Maltby, d. 3/20/1818, ae. 34  
 467, Bunce Joshua, son of Jacob, d. 9/29/1741, ae. 4 yr.  
 140, Carll Selah, d. 11/30/1864, ae. 93  
 141, Seraphina, w. of Selah, d. 11/26/1878 ae. 99  
 154, Carll Hannah, w. of Scudder, d. 3/3/1802, ae. 25  
 479, Calder Dorothy Anne, d. 5/22/1887, ae. 5 yr.  
 479, " Augusta Celia, d. 10/27/1887, ae. 24  
 120, Chichester Sylvanus, d. 5/15/1828 ae. 89 yr. 3 da.  
 121, " Hannah, d. of Ebenezer & Olive, d. 6/1/1810, ae 10 weeks.  
 122, " James, son, d. 6/23/1815, ae. 25 da.  
 150, " David, d. 3/5/1764  
 287, Chandler, Sylvester, son of Sylvester & Eliz. d. 10/12/1843, ae. 1yr. 3 da  
 288, " Elizabeth, wife of Sylvester, dau. Burr Buckley, d. 9/6/1843 ae. 29y8m  
 5, Conklin Mary, w. of Silas, d. 9/12/1827, ae. 51-10-26  
 6, " Silas, d. 3/29/1854 ae. 81-6-23  
 55, " Zuriiah, w. of John, d. 8/16/1857, ae. 75 yr.  
 56, " Hannah, dau. of John & Zuriiah, d. 1/9/1826 ae. 22 yr.  
 57, " John d. 12/8/1825 ae. 46  
 77, " Isaac, d. 9/29/1810, ae. 29-9-9  
 82, " Richard, d. 5/15/1818 ae. 70  
 84, " Abigail, w. of Richard, d. 10/4/1794 ae. 51  
 85, " Elizabeth w. of Capt. Cornelius, d. 12/14/1803 ae. 77yr.  
 86, " Cornelius Capt., d. 9/11/1791, ae 64  
 88, " Seth, son of Richard & Abigail, d. 9/27/1795, ae 20.  
 88, " ----, older brother, died at sea, d. 9/1791, ae. 22  
 90, " Martha, dau. Richard & Abigail, d. 9/9/1798 ae. 19.  
 91, " Henry, d. 9/14/1798, ae. 28  
 92, " Strong, d. 8/1/1835, ae. 68-2-26  
 93, " Ruth, w. of Strong, d. 1/25/1847, ae. 74y. 1mo.  
 94, " Nathan, s. of Strong & Ruth, d. 1/24/1801, ae. 14 da.  
 95, " (still-born) dau. of above, 5/2/1805  
 95, " Mary, dau of above, d. 5/25/1810, ae. 3yr. 9mo.  
 96, " Abigail, dau. of above, d. 11/8/1826, ae. 30-10-4  
 97, " Nathan, d. 10/11/1849 ae. 48-7-1  
 113, " Elizabeth, d. 4/22/1841, ae. 46  
 114, " Mary, w. of Richard, d. 8/6/1828, ae. 66  
 115, " Richard, d. 8/11/1818, ae. 62 PRISONER OF WAR  
 116, " Buel d. 2/12/1822 ae. 51  
 147, " Ruth, w. of Timothy, d. 4/8/1788 ae 43  
 166, " Hubbard, d. 5/19/1806, ae. 69-7-12  
 167, " Mary, w. of Hubbard, d. 12/9/1786  
 168, " Experience, dau. of Hubbard & Mary, d. 10/29/1781, ae. 20

- 169 Conklin Hubbard, s. of Hubbard & Mary, d. 7/8/1779, ae. 8m. 17da.  
 170 " Gilbert, s. of above, d. 9/19/1776, ae. 9-317  
 171 " Keturah, dau. of Timothy, d. 12/12/1773 ae 5yr.  
 172 " Ruth, w. of Timothy, d. 10/9/1781, ae. 49yr. 7 m.  
 173 " Timothy, d. 5/22/1811, ae. 79  
 174 " Keturah, dau. of Abel & Ruth, d. 9/17/1793 ae. 7yr.  
 175 " Ruth, Ist. w. of Abel, d. 6/20/1790, ae 26yr. 4 mo.  
 176 " Abel, d. 7/12/1827, ae. 64  
 177 " Mindwell, 2nd. w. of Abel, d. 9/13/1855 ae. 86  
 178 " Elizabeth, b. 3/12/1801, d. 2/10/1883  
 179 " Ruth, b. 11/12/1804, d. 11/14/1883  
 183 " Peleg, s. of Thomas & Mary, d. 1/27/1788, ae 17yrs.  
 186 # Emma, dau. Timothy & Mary, d. 2/4/1791, ae. 1yr. 29da.  
 187 " Col. Timothy, d. 10/17/1831 ae. 77-10-17  
 188 " Mary, w. of Timothy, d. 10/2/1838 ae, 82yr. 4mo.  
 193 " Warren, s. of Warren & Rebecca, d. 10/7/1838 ae. 5mo. 15da.  
 203 " George W., d. 10/8/1854, ae. 42-II-I  
 215 # Selah, d. 9/15/1797, ae. 45  
 216 " Thomas, d. 3/26/1802, ae. 7I-II-26  
 217 " Capt. John, d. 9/14/1757, ae. 53 yr.  
 219 " Richard Morrow, s. Rich. & Mary, d. 7/28/1823, ae. 1yr. 28 da.  
 219 " ~~Isaac W.~~ (no name) infant dau. same grave.  
 224 " Isaac W., d. 6/3/1852, ae. 43 yr.  
 224 " Francis, son, (in memory of) (lost at sea) 3/2/1872, ae. 33yr.  
 225 " James Haviland, S. of Issac & Abigail, d. 2/22/1844 ae. 8mo. 9da.  
 231 " Keziah, w. of Benjamin, d. 10/25/1825, ae. 8I-3-24  
 285 " Gilbert, s. of Samule & Elizabeth, d. 10/1/1747, ae. 9 da.  
 291 " Theodore, s. of Abel & Mary, b. 4/27/1835, d. 9/3/1835  
 292 " Jerusha Buell d. of Abel & Mary, b. 7/25/1831, d. 7/7/1833  
 293 " Mary, w. of Abel K., b. 7/12/1802, d. 6/21/1835  
 294 " Abel K., d. 8/6/1845 ae. 48  
 295 " Mary, w. of Abel K., d. 11/15/1888 ae. 80 yr.  
 306 " John Suydam, s. of Anselem h. & Ellen, d. 11/11/1850 ae. 3yr. 9mo.  
 325 " John, d. 1751 (no stone)  
 326 " Mary, w. of John, d. 11/27/1749 ae. 7I yr.  
 332 " Caroline, dau. Erastus & Sarah M., d. 10/3/1845, ae. 1yr. 25 da.  
 406 " Mary, w. of David, d. 10/23/1846, ae. 73 yr.  
 407 " David, d. 1/10/1858 ae. 85-8-29  
 204 Crosby Amelia, w. of Roswell, d. 2/3/1866, ae. 80  
 205 " Roswell, d. 2/18/1848, ae. 67yr.  
 431 Crossman, infant dau. of Gilbert & Mary G., d. 10/2/1839  
 431 " infant son, of above, d. 2/16/1841, ae. 3da.



- . PB 4
- 1, Denton Samuel, d. 10/27/1860, ae. 76-8-15
  - 2, " Hannah, w. of above, d. 1/7/1857, ae. 68yr. 5mo.
  - 355, Deen(e) infant s. of Wm. & Caroline, d. 10/22/1836
  - 439, Deen Esther, w. of Joseph, d. 12/21/1743 ae. 46 yr.
  - 221, Douglas Narcissa, dau. Wm. & Susan, d. 12/31/1835 ae. 26-3-21
  - 263, " Wm., d. 4/25/1852, ae. 84 yr. 1 mo.
  - 264, " Susan, w. of Wm., d. 4/28/1850, ae. 77yr.
  - 333, Downs, infant son of Isaac & Sarah, d. 10/27/1846
  - 346, Demarest Phebe, d. 1/24/1823 ae 70
  - Denton Hannah, b. 10/16/1821 d. 10/27/1896 } same stone
  - " Mary A., b. 10/24/1819, d. 4/14/1900 }
  - 356, Fancher Lysander, d. 7/13/1859 ae. 62 yr.
  - 312, Ferris, Enoch George, s. of Rev Ira & Mary, d. 3/9/1835, ae. 6yr.
  - 338, Llandreau, VanKensselaer, s. of Daniel & Sally, d. 6/26/1836, ae. 22-2-8
  - 465, Finchley Sarah, w. of George, d. 3/3/1842, ae. 79 yr.
  - 151, Fleet Frances<sup>Wm.</sup>, w. of Thomas, d. 6/1/1840, ae. 77yr.
  - 152, " Thomas d. 1/8/1818, ae 80yr.
  - 153, " John, d. 1/6/1800 ae. 23 yr.
  - 155, " Isaac, d. 4/5/1814 ae. 37 yr.
  - 156, " Samuel, s. of Gilbert & Keziah, d. 5/10/1828 ae. 16-5-28
  - 157, " Gilbert, d. 5/1/1839, ae. 54 yr.
  - 158, " Keziah, w. of Gilbert, d. 3/14/1874, ae. 90yr. 7mo.
  - 163, " Henry, s. of John & Phebe, d. 8/5/1821 ae. 14 da.
  - 237, Fowler Iantha, w. of Chas. H., d. 9/5/1882, ae. 67-9-15
  - 239, " Charles H., d. 9/10/1859 ae. 54
  - 428, Gould Mary, w. of Thomas C., d. 10/12/1844, ae. 25-1-18
  - 429, " Clarissa, dau. of David & Mary, d. 5/26/1808, ae. 6yr. 5mo.
  - 430, " Amelia, dau. of above, d. 6/5/1808, ae. 2yr. 10mo.
  - 432, " Wm. Schenck, s. of above, d. 9/7/1821, ae. 10mo. 8da.
  - 395, Griffith Jesse, d. 7/15/1855, ae. 67yr.
  - 396, " Hannah, w. of Jesse, d. 12/18/1848 ae. 58 yr.
  - 438, " Edward H., s. of Albert & Catharine, d. 11/7/1860, ae. 1-6-7
  - 144, Haviland Jacob, s. of Wm. & Deborah, d. 2/9/1832 ae. 53yr. 10 mo.
  - 145, " Deborah<sup>Wm.</sup>, w. of Wm. d. 7/15/1836 ae. 87 yr. (SMITH TOWN)
  - 146, " Wm. d. 10/21/1798 ae. 60 yr.
  - 159, " John, d. 9/9/1800, ae. 69 yr.
  - 160, " Rachael, w. of John, d. 10/19/1798 ae. 87
  - 161, " Isaac, d. 12/27/1774, ae. 30 yr.
  - 162, " Samuel, d. 7/15/1827, ae. 82 yr. 5mo. ( builder of Ist. Church, 1784)
  - 482, Hammond ----, d. 3/3/1838, ae 24 yr.
  - 456, Howard Homer, s. of Jonathan & Clarissa, d. 8/3/1846, ae. 14-4-22
  - 457, " Oscar E., d. 4/19/1848, ae. 6mo. 12da.
  - 457, " LeGrand, d. 3/5/1853, ae. 3-3-3
  - 328, Huyck Clarissa, w. of John H., d. 1/6/1851, ae 81 yr.
  - 61, Horton Letty Augusta, d. of James & Mary, d. 4/4/1837, ae. 7mo. 19da.
  - 18, Hawkhurst Juliann, w. of Ephriam, d. 11/22/1823, ae. 21yr.

- 484, Jackson Charles, d. 9/II/1875, (Colored)  
338, Jarvis Philetus, B. 12/I/1806, d. 3/4/1891  
339, " Almeda, w. of Philetus, b. 6/18/1806, d. 1.II.1890  
330, " Philetus M., s. of Philetus & Almeda B., d. 7/18/1850, ae. 4-3-24  
331, " Wilmer, s. of above, d. 6/28/1850, ae. 2-7-26  
332, " Margaret C., dau. of above, d. 6/10/1844 ae. 7-II-27  
333, " Children of Margeret S., d. 3/2/1831 ae. 2mo. 13da.  
333, " Margaret Scudder, d. 1/2/1835, ae. 2-2-20  
333, " Cornelia E., d. 1/13/1835, ae. 11mo. 11da.  
334, " Frederick M., s. of Philetus & Almeda, d. 12/9/1851, ae. 4mo 17da.  
335, " Philetta W., adopted dau. of above, d. 3/16/1858, ae. 7-4-12  
336, " Ruth, w. of Eliphelet, d. 9/27/1784 ae. 42 yr.  
334, " Susannah, w. of Eliphelet, d. 12/25/1804 ae. 64yr.  
206, Johnson Hester, d. 5/14/1886, ae. 58-6-22  
408, " Reuben, d. 10/17/1846 ae. 32yr.  
409, " Abiathar, s. of Wm. & Margaret, d. 10/10/1801, ae. 12yr. 3mo.  
410, " Oliver, d. 3/16/1836, ae. 52yrs.  
411, " Deborah Ann, d. 6/13/1838 ae. 30 yr.  
412, " Rebecca, dau. of Oliver & Mary, d. 4/10/1839 ae. 22-II-16  
413, " Mary, w. of Oliver, d. 7/9/1841, ae. 55yr. 6da.  
414, " Mary, w. of Samuel C., b. 10/10/1785, d. 3/6/1876  
415, " Samuel C., b. 4/15/1780, d. 9/16/1854  
416, " Mary S., b. 6/15/1829, d. 3/15/ 1894  
418, " Joshua H., d. 10/5/1854 ae. 38  
418, " Elizabeth H., b. 2/27/1819, d. 8/31/1899  
460, Jones James, d. 8/25/1817, ae. 82yr.  
461, " Israel B., d. 10/1/1886, ae. 93 yr.  
462, " Uriah, d. 7/14/1817, ae. 23 yr.  
463, " Sarah B., d. 11/23/1817 ae. 20 yr.  
---- Johnson, Henrietta F., d. 10/1/1903, ae. 90-7-18  
322, Kelcy Susan, w. of Woodhull S., d. 11/18/1844, ae. 28yr.  
419, " Platt, d. 2/11/1826, ae. 38yr. 6mo.  
42, Ketcham Silas T., b. 6/8/1802, d. 10/16/1859  
42, " Phoebe, w. of Silas, b. 5/31/1806, d. 3/20/1867  
47, " Sarah, dau. Silas & Elizabeth, d. 12/11/1814 ae. 6 weeks  
48, " Letty Ann, dau of above, d. 5/10/1816 ae. 7-7-18  
49, " Silas, d. 2/17/1823, ae. 46yr.  
50, " Elizabeth, w. of Silas, d. 11/4/1852, ae. 70-7-28  
51, " Wm. N., s. of Silas & Elizabeth, d. 1/9/1826 ae. 3-9-6  
52, " Charles W., s. of above, d. 10/29/1831, Ae. 7yr. 21da  
53, " Wm. H., s. of above, 3/30/1831, ae. 5-3-5  
54, " Elizabeth, dau. of above, d. 10/23/1834 ae. 19-II-23  
64, " Sarah, dau of John & Elizabeth, d. 6/10/1819 ae. 38yr.  
65, " Titus, s. of above, d. 10/31/1791 ae. 1-1-10  
66, " Stephen, d. 11/23/1792, ae. 66yr. *SIGNED - A334.*  
67, " Anne, <sup>W.</sup> w. of Stephen, d. 2/18/1803 ae. 73yr. 22da. \* *DUMPED - HIT WATER -*  
68, " Elizabeth, w. of John, d. 4/4/1813, ae. 57yr. *FROM - LOOKING - POT - ON*  
*ENGLISH - SEE "OLD-TIMES*  
*IN - HUNTINGTON"*



137 6

69, Ketcham John, d. 12/29/1829 ae. 77-II-II SIGNED. ASSOP. 1856  
70, " Nathaniel, d. 2/19/1758, ae. 79yr.  
334, " John D. s. of Woodhull & Ellen, d. 1/10/1858, ae. 7mo. 12da.  
335, " Mary Caroline, dau. Woodhull & Mary Ann, d. 3/2/1847, ae. 3mo. 24da.  
336, " Samuel Francis, s. of above, d. 12/21/1850, ae. 3mo. 22da.  
337, " Mary Ann, w. of Woodhull, d. 11/8/1851, ae. 35yr.  
378, # Harriet, dau. Zophar & Elizabeth, d. 11/11/1842, ae. 2mo. 16da.  
379, " Ellen Augusta, dau. of above, d. 9/4/1852, ae. 16yr. 3mo.  
380, " Elizabeth, w. of Zophar, b. 7/16/1816, d. 3/27/1892  
381, " Zophar, b. 5/22/1811, d. 11/2/1894  
392, " Elizabeth, d. 1/23/1865, ae. 62 yr.  
393, " Jacob, d. 1/22/1881, ae. 80yr.  
394, " Margaret, d. 9/3/1867 ae. 55yr.  
27, " Mary, d. 4/13/1873, ae. 92 yr.  
16, Lefferts Ebenezer C., d. 9/14/1835 ae 23yr.  
17, " William, d. 6/27/1824 ae 27yr.  
19, " Henry, d. 6/29/1844 ae. 74 yr.  
20, " Ruth, w. of Henry, d. 3/29/1853, ae. 81 yr.  
58, " Gilbert C., d. 4/30/1831 ae. 42 yr.  
59, " Stephen S., s. of George & Letty, d. 8/31/1817 ae. 10mo.  
62, " Charlotte, w. of John, d. 1/16/1810, ae. 45 yr.  
63, " John, d. 12/29/1839, ae. 73yr.  
78, " Sarah, w. of Leffert, d. 10/6/1853 ae. 78yr.  
79, " Leffert, d. 4/27/1828 ae/ 55yr.  
117, " Adam, d. 3/22/1831, ae. 75-2-16  
80, Lefford William, d. 1/30/1808, ae. 28-II-24  
165, Long Richard, d. aug.-- 1818 ae. 33yr.  
307, " Joseph Henry 2nd. s. of Edward & Sally, d. 7/27/1853, ae. 7mo. 10da.  
316, " John S., d. 3/15/1825 ae. 32yr.  
317, " Hewlett J., d. 12/6/1824 ae. 34yr. 6mo.  
318, " David, d. 10/24/1815, ae. 37yr. 2mo.  
319, " Martha C., dau. of James & Hannah, d. 8/21/1815 ae. 27yr.  
320, " James, s. of David & Rebecca, d. 7/5/1824, ae. 21yr. 7mo.  
320, " Epenetus (died at sea) d. 5/9/1835, ae. 25yr. 7mo.  
433, " Sarah, w. of James, d. 1/20/1847 ae. 55yr.  
434, " James, d. 4/28/1849 ae. 63yr.  
435, " Hannah Maria, w. of John S., d. 1/7/1851, ae. 27yr. sister dau of  
436, " Jane Amelia, W. of John S., d. 12/26/1859 ae. 29yr. " Ebenezer  
Smith.  
452, Mahan Farnum, s. of Francis & Sarah, d. 8/1/1848, ae. 5mo. 5da.  
453, " Adrian C., son of above, d. 3/15/1841, ae. 1-II-I  
454, " Emily F., dau of above, D. 2/21/1856 ae. 3-2-14  
402, Mathias Catherine, w. of Morehouse, d. 5/12/1826, ae. 53yr.  
403, " Morehouse, d. 6/3/1822, ae. 59 yr.  
30, Mather Alexander, (Capt.) d. 5/14/1826 ae. 70yr.  
31, " Prudence, w. of above, d. 4/17/1860, ae. 84yr. 5mo.  
476, Mathews Edward, d. 12/29/1865, ae. 55yr.  
476, " Also for Samuel, lost at sea on Steamer Pacific, 1856  
477, " Mary, d. 10/25/1849 ae. 69.yr.  
478, " Thomas, d. 9/14/1849, ae. 66yr.  
197, Meng Sarah, w. of Christopher, d. 8/26/1787, ae. 27yr.  
198, # Sarah, d. 3/2/1788, d. 3/2/1785 ae. 6mo.  
199, " Henry, d. 7/13/1789 ae. 4yr.  
222, " Jane, w. of Christopher, d. 11/22/1846 ae. 84yr.  
223, " Christopher, b. 6/8/1750, d. 1/12/1833

1867

417, Merrill George D., d. 2/9/1872, Ae. 58-1-22  
 321, Mott, John, A., d. 11/30/1840 ae. 32-6-9  
 321, Also John Evans s. of above and Margaret, b. 3/19/1841 ae. 5mo. 5da.  
 471, Mullen Mary Ann d. 5/23/1847, ae. 6yr. 1mo. (dau. of Patrick)  
 28, Nostrand Charity, w. of Forster, d. 4/6/1853 ae. 92yr.  
 29, " Forster, d. 5/20/1815, ae. 56yr.  
 180, Platt Elizabeth, w. of Zebulon, d. 3/14/1814, ae. 59yr.  
 181, " Zebulon, d. 7/23/1816 ae. 76yr. SIGN SD: ASSC. = PRISONER - OR - "SWAN"  
 182, " Phoebe, d. 1/30/1790, ae. 39yr. w. of Zebulon  
 189, " Jonas, d. 12/10/1804 ae. 77-1-18  
 190, " Rebecca<sup>W.</sup> of Jonas, d. 6/28/1805 ae. 70-1-26  
 191, " Amos, d. 8/31/1821, ae. 62yr.  
 191, " also two infants of above and Clarissa, 9/29/1820 ae. 9da. (sons)  
 192, " Clarissa, w. of Amos d. 2/23/1834, ae. 67yr.  
 210, " Zuriyah, w. of Amos, d. 11/5/1744 ae. 39yr.  
 360, " Prudence, w. of Elkanah, d. 6/8/1845 ae. 75yr.  
 361, " Elkanah, d. 1/1/1842, ae. 71yr.  
 364, " Isaac (Capt), d. 2/5/1763 ae. 64yr.  
 366, " Esther, w. of Scudder, d. 8/22/1806 ae. 47yr.  
 367, " Zophar, d. 11/1/1812 ae. 27yr.  
 368, " Scudder, d. 11/29/1829, ae. 70yr.  
 369, " Zophar (Esq) d. 3/27/1811 ae. 77yr.  
 370, " Sarah, w. of Zophar Esq., d. 5/10/1811 ae. 77yr.  
 373, " Jane Williams, dau. John & Charlotte, d. 10/3/1821, ae. 6yr. 10mo.  
 374, " Hannah (Oakley), w. of Israel, d. 5/14/1837, ae. 71-1-19  
 375, " Israel, d. 1/21/1848, ae. 83-3-26  
 376, " Jesse, d. 8/4/1837, ae. 42-2-13  
 377, " Abigail, d. 3/1/1883, ae. 86yr. 5mo.  
 382, " Francis Asbury, s. of Isaac & Elizabeth, d. 10/8/1827, ae. 1yr. 26da.  
 383, " David, d. 6/27/1822 ae. 32yr.  
 384, " Ira, s. of Jesse & Deborah, d. 4/9/1795, ae. 2yr. 3mo.  
 385, " Lankey, w. of Ira, d. 5/1/1822 ae. 23yr.  
 385, " also an infant dau. ae. 1 da.  
 386, " Ira, d. 8/25/1825, ae. 30yr.  
 " also s. of Ira & Keturah, d. 9/16/1825 ae. 14mo.  
 387, " Jesse, d. 11/25/1827, ae. 65yr.  
 387, " Deborah<sup>W.</sup> of Jesse, d. 12/31/1849 ae. 84yr.  
 389, " Isaac, d. 8/8/1849, Ae. 86-2-24  
 391, " John, s. of Israel & Hannah, d. 5/2/1862 ae. 73yr.  
 420, " Obadiah, d. 12/7/1829, ae. 84yr.  
 421, " Mary, w. of above, d. 6/7/1825, ae. 85yr.  
 422, " Drake W., d. 8/17/1849, ae. 30yr.  
 422, " infant son of above & Caroline, d. 1/1/1848  
 425, " Content, w. of Philetus d. 4/11/1832 ae. 59yr.  
 482 Phisco Experience, d. 3/25/1822 ae. 26 yr.  
 437, Randall John, d. 8/30/1860 ae. 76yr.  
 313, Robertson James, s. of Rev. Samuel & Dorcas, d. 2/8/1819, ae. 5mo. 15da  
 327, Redfield James P., d. 8/23/1832 ae. 46yr.



269, Roe James P., d. 2/5/1888 ae. 70yr. 7mo  
 270, " Joseph S., s. of above, d. 6/1/1850, ae. 7/2/13  
 268, " Clarisa H. w. of James P., d. 2/22/1880 ae. 64-8-2  
 271, " Keturah, w. of Joseph S., d. 12/8/1880, ae. 85yr.  
 272, " Joseph S., d. 10/18/1822 -----  
 273, " Mary, w. of Thomas, d. 12/11/1840, ae. 77yr.  
 274, " Thomas, d. 2/14/1820, ae. 61yr.  
 278, " Martha, w. of Philips Roe, (widow of Jos. Smith) d. 2/9/1817, ae. 82yr  
 40, Rogers Ralph Austin, s. of Moses & Adeline, d. 3/5/1854 ae. 5yr. 2mo.  
 40, " Edgar Irving, d. 10/2/1854, ae. 1yr. 10mo.  
 41, " Alonzo Platt, s. of Moses & Adeline, d. 1/16/1874, ae. 2-3-9  
 44, " Platt, b. 9/5/1796, d. 1/18/1863  
 45, " Experience, w. of Platt, b. 4/19/1797, d. 10/13/1860  
 46, " John L., s. of above, d. 11/13/1844, ae. 19yr. 7da.  
 118, " Daniel, d. 7/12/1839, ae. 60yr.  
 119, " Rebecca, w. of Samuel, dau. Rich. & Mary Conklin, d. 12/4/1847 ae. 56y  
 129, " Richard, s. of Titus & Elizabeth, d. 12/28/1831 ae. 1-2-17  
 139, " Rebecca, w. of Zephania, d. 5/11/1851 ae. 80 yr.  
 139, " Zephania, d. 8/19/1824 (b. 9/30/1744) ?  
 340, " Jackson, J., d. 2/11/1838, ae. 4-4-17  
 340, " James, d. 4/23/1830, ae. 2/1/12, sons of Wm. & Charlotte  
 359, " Lydia, 2nd. w. of John, d. 12/1/1839, ae. 53yr.  
 371, " Anna, w. of John, dau. Zophar & Sarah Platt, d. 7/3/1824, ae. 54yr.  
 372, " John, d. 4/7/1843, ae. 79yr.  
 397, " Bradford, d. 4/28/1853 ae. 58yr. 5mo.  
 398, " Eliza Willett w. of Bradford, d. 9/8/1849 ae. 38yr. 3da.  
 399, " George Bradford, s. of above, d. 8/14/1871 ae. 34/11/27  
 --- Roe, Chas. W., s. of James & Clarissa d. 5/8/1899, ae. 50-7-13  
 211, Busco Silas, d. 2/13/1811, ae. 46yr.  
 212, " Judith, w. of Silas, d. 3/9/1823  
 213, " Jonas S., d. 10/1/1821 ae. 26 yr.  
 214, " Hannah d. 1/3/1853, ae. 53yr.  
 440, " Sarah, dau. David & Jemima, d. 2/4/1764, ae. 3yr.  
 441, " Hannah, dau. of above, d. 10/12/1773, ae. 14yr.  
 442, " Jemima, <sup>supp</sup> w. of David, d. 4/10/1799, ae. 71yr.  
 443, " David, d. 10/12/1815, ae. 91yr.  
 444, " Hannah, w. of David Jr., d. 2/2/1820, ae. 66yr.  
 445, " David Jr., d. 1/10/1805, ae. 51 yr.  
 446, " Nathaniel, d. 11/3/1830, ae. 47yr. 7Mo.  
 424, Sackett Wm. H., d. 2/28/1846 ae. 43 yr.  
 60, Sammis Letty, w. of Smith, d. 9/13/1855 ae. 46-1-2  
 81, " Nathaniel, B., s. of Platt & Keturah, d. 11/16/1835 ae. 8-6-22  
 82, " Platt, d. 10/30/1837 ae. 71 yr.  
 98, " Sarah, w. of Jonas, d. 4/17/1810, ae. 32-1-16  
 99, " Jonas, d. 4/14/1784, ae. 46 yr.  
 100, " Rebecca, w. of Jonas, d. 10/22/1808 ae. 66yr.  
 101, " Elizabeth, w. of Henry, Dau. Thos. & Eliz. Betts, Norwalk Ct. d. 3/25/1827, 39yr  
 102, " Solomon, s. of above, d. 3/27/1827 ae. 16yr.  
 103, " Geo. Betts, s. of above, d. 6/23/1844, ae. 21yr. 13da.  
 104, " Ebenezer, d. 4/29/1816 ae. 31-2-17  
 109, " Deborah, dau. of Wm. & Sarah, (Conklin) d. 10/17/1804 ae. 25yr.  
 110, " Hannah, dau. of above, d. 1/1/1809 ae. 32yr.  
 111, " Experience, w. of Wm. d. 2/2/1834, ae. 52yr.  
 112, " Wm. d. 3/25/1849 ae. 68yr.  
 123, " Phebe, d. 10/18/1849, ae. 64yr.  
 124, " Sarah, d. 6/1/1855, ae. 87  
 125, " Susan M., dau. Wm. & Experience, d. 1/8/1880 ae. 70yr. 4mo.



1215 1/2 - 1215 1/2 - 1215 1/2 - F - D - 5-2-1957

- 127, Sammis Phebe, w. of Ebenezer, d. 8/I/1837, ae. 93yr.  
 232, " Selucas, s. of Jesse & Almira, d. 2/II/1837, ae. I-5-12  
 250, " Jesse F., d. 12/26/1880, ae. 81-4-22  
 251, " Mary Esther, w. of Jesse F., d. 3/2I/1845, ae. 31yr.  
 252, " Olli Ann, w. of Jesse F., d. 12/12/1834, ae. 26yr.  
 253, " Adelia B., w. of Louis, d. I/15/1828, ae. 23yr.  
 254, " Thankful, w. of Mr. Jesse, d. II/9/1814, ae. 71 yr.  
 255, " Jesse, d. I/6/1816, ae. 79 yr.  
 256, " Marietta, w. of Richard Jr., d. 12/II/1826 ae. 24yr.  
 257, " Wm. H., s. of Lewis & Adelia B., d. 4/29/1837, ae. 9yr.  
 258, " Deborah, w. of Lewis, d. 8/4/1838, ae. 27yr.  
 259, " Epenetus, d. 12/2I/1839 ae. 73yr.  
 260, " Experience, w. of Epenetus, d. 4/2I/1842, ae. 72yr.  
 262, " Mary (Carpenter), w. of David, d. 6/8/1835, ae. 75yr.  
 283, " David, d. 4/29/1820, ae. 58yr.  
 284, " Luther C., d. 4/30/1831, ae. 40yr.  
 226, Satterly Nathaniel, s. of John & Mary, d. 5/3/1759, ae. 16yr.  
 227, " Deborah, dau. of above, d. 6/25/1753, ae. 15yr.  
 228, " John, d. I/28/1749-50, ae. 38yr.  
 148, Scidmore Hannah, w. of Samuel, d. I/I7/1797, ae. 22-I-I4  
 149, " Samuel, d. 4/20/1828 ae. 58yr.  
 296, Scofield Sarah D., dau. Henry & Eliza, d. 6/25/1838, ae. 2yr. II mo.  
 297, Susan, dau. of above, d. 6/19/1842, ae. 1yr.  
 298, Henry, d. 6/3/1853, ae. 49-3-II  
 329, Selleck Lewis, d. 7/20/1855, ae. 57yr. 7mo.  
 330, " Moses Mather, s. of Lewis & Polly, d. 5/10/1835, ae. 7yr.  
 331, " Harriet, w. of Charles, d. II/7/1858 ae. 32yr.  
 331, " also infant son, d. II/4/1858  
 353, " Eunice, w. of Raymond, d. 8/I/1861, ae. 78-7-3  
 354, " Raymond, d. I/5/1847, ae. 65-5-24  
 362, " Phebe, w. of George, d. I/7/1847, ae. 24-2-23  
 363, " George, d. 2/2/1849, ae. 55-5-25  
 143, Scudder Nathaniel, d. 6/15/1866 ae. 68yr. 4mo.  
 390, " Sarah W., w. of John, d. 2/I7/1851 ae. 49yr.  
 472, " Sarah, dau. Moses & Elizabeth, 10/I6/1758 ae. 12yr.  
 473, " Elizabeth w. of Jonathan, d. 9/2/1773, ae. 36yr. II mo.  
 474, " Jonathan, d. 5/I2/1814, ae. 77yr.  
 481, " Sarah Elizabeth, d. 4/22/1839, ae. 3-3-16 } daughters of Henry P.  
 481, " also Phebe Louisa, d. 12/I/1841, ae. 3-8-25 } and Louisa  
 107, Slessor John C., s. of Mary & John, d. 12/5/1805 ae. 4 yr.  
 108, " Mary, w. of John, d. I/9/1807, ae. 38yr.  
 21, Smith Clara A., d. II/23/1832 ae. 33yr.  
 22, " Temperance Ketcham, w. of Epenetus, d. 4/I5/1839, ae. 73 yr.  
 23, " Epenetus, d. 9/9/1839, ae. 80 yr.  
 24, " Charles W., d. 12/20/1849 ae. 55yr.  
 25, " ~~William~~ W., w. of above, d. 8/2I/1833, ae. 35-6-6  
 76, " Nathan, d. 2/I4/1811, ae. 40yr.  
 87, " Elizabeth w. of Nathan, d. 8/I6/1795 ae. 22yr.  
 89, " Elizabeth C., dau. Nathan & Elizabeth, d. 8/3I/1798, ae. 5yr.

- 276, Smith Joseph, d. 6/12/1773 ae. 45 yr.  
 277, " Rebecca, w. of above, d. 1/18/1758, ae. 62yr.  
 348, " Platt, d. 12/24/1881 ae. 62yr.  
 349, " Jesse B., d. 3/13/1841, ae. 27-10-18  
 350, " Richard H., s. of Gilbert & Hannah, d. 9/9/1837, ae. 14-2-16  
 351, " Gilbert, d. 8/4/1842, ae. 78yr.  
 352, " Hannah, w. of Gilbert, d. 12/15/1864, ae. 76yr.  
 365, " Gilbert Platt, s. of Nathaniel & Phebe, d. 8/22/1813, ae. 5yr. 3mo.  
 485, " Phebe, w. of Nelson, (colored) d. 1/28/1845 ae. 34 yr.  
 486, " Nelson, (colored) d. 5/27/1838 ae. 90yr.  
 487, " Mary Esther, (colored) dau. of above, d. 10/17/1840 ae. 3-6-18  
 3, Titus, Alida, w. of Jonas, d. 9/9/1881 ae. 67-6-14  
 4, " Jonas, d. 4/19/1883, ae. 81yr.  
 33, " Joel M., s. of Henry W. & Susan A., d. 5/17/1830, ae. 2mo.  
 34, " Andrew, s. of Henry & Abigail, d. 9/28/1819, ae. 10yr. 10mo.  
 35, " Henry, d. 3/23/1839, ae. 74yr.  
 36, " Abigail, w. of Henry, d. 1/19/1862, ae. 88yr.  
 37, " Joel, d. 2/3/1851, ae. 52yr.  
 38, " Mary, d. 6/24/1871, ae. 76yr.  
 39, " Wm. L., d. 1/13/1884, ae. 78-1-19  
 235, " Henry S., s. of Zebulon & Mary, d. 4/8/1843, ae. 22-1-22  
 236, " Zebulon, d. 3/13/1848 ae. 62-5-13  
 237, " Mary, w. of Zebulon, d. 1/29/1852, ae. 58-1-12  
 300, " Esther, dau. Jacob & Esther, d. 10-3-1846, ae. 6-2-11  
 301, " Esther, " " d. 5/12/1848, ae. 1yr.  
 302, " (Hester) w. of Jacob, d. 12/10/1855 ae. 52yr.  
 303, " Jacob, d. 1/26/1865 ae. 64yr.  
 304, " William, s. of Jacob & Hester, d. 11/25/1854 ae. 21-6-25  
 305, " Jacob H., s. of above, d. 11/5/1864, ae. 22yr. 5mo.  
 466, " Mary, w. of Abiel Jr., d. 7/25/1735 ae. 32yr.  
 7, Vail Abigail, w. of Philetus, d. 9/23/1842 ae. 54yr.  
 261, Van Velsor, Mary E., w. of Mortimer, b. 9/7/1833, d. 4/9/1894  
 262, " Mortimer, b. 5/24/1836 d. 3/14/1881  
 8, Van Wyck Abraham, b. 10/21/1767, d. 1/30/1852  
 9, " Zeruah, w. of above, b. 10/15/1771, d. 5/22/1851 ae. 79-7-7  
 10, " Sarah, dau. of Abraham & Zeruah, d. 10/28/1815  
 11, " infant son of J.H. & Sarah M., 4/2/1826  
 12, " Susanah, dau. of Above, d. 11/24/1834, ae. 2-2-6  
 13, " Ellen G., w. of Samuel A. d. 1/7/1881 ae. 73yr. buried in Trinity Cem.  
 14, " Samuel A., d. 5/19/1875, ae. 81-3-25 sons of N.Y.C.  
 15, " Abraham H., d. 6/24/1849, ae. 50-10-11 Abraham  
 --- Velsor, Charles 2/3/1842---8/15/1899  
 2 Cecelia F. 10/22/1842---9/13/1916

219, Warren Ira P., s. of Rufus, d. 4/8/1838 ae. 23-6-4  
 105 West Lydia, w. of Thomas, d. 7/9/1781, ae. 25-3-22  
 142, Weiss Ann, d. 10/18/1817, ae. 72yr.  
 164, " Sarah Ann, d. 10/12/1825, ae. 27  
 70, Whitson George, s. of Samuel & Sarah, d. 9/19/1836, ae. 27yr.  
 71, " Sarah, w. of Samuel, d. 12/5/1838 ae. 58  
 72, " Samuel, d. 3.17/1853 ae 77yr.  
 73, " Sarah, dau. Samuel & Sarah, d. 10/1/1864, ae. 53yr.  
 74, " John, d. 8/30/1863, ae 43yr.  
 75, " Charles, d. 12/13/1881, ae 77yr.  
 357, " Edward Payson, s. of Smith & Phebe, d. 9/8/1848, ae. 2-5-15  
 358, " Albert H. s. of above, d. 9/14/1886, ae. 18-3-24  
 404, Wheeler Hannah, w. of Epenetus, d. 2/7/1809, ae. 19-10-12  
 323, White Ananias, b. 1/25/1788, d. 3/13/1849  
 324, " Sybil C., w. of above, b. 6/9/1791, d. 8/10/1877  
 405, Wickes Anna, w. of Lemuel, d. 1/17/1810, ae. 57-2-8  
 426, " Sarah, w. of Gilbert, d. 5/4/1792 ae. 62yr.  
 427, " Sarah, w. of Gilbert Jr., d. 3/12/1795, ae. 36yr. 12da.  
 455, " Warren Franklin, s. of John H. & Abigail, d. 3/3/1840 ae. 10-8-3  
 194, Williams Nathaniel Sr. d. 11/27/1781 ae. 60yr. 9 mo.  
 195, " Rachel (Fleet), w. of Nath. d. 3/14/1791 ae 66yr.  
 200, " Israel, s. of Timothy & James, d. 9/20/1798, ae. 4yr.  
 201, " Timothy, d. 8/20/1811, ae. 55yr.  
 202, " Mary Jane, dau. Edward & Rebecca, d. 12/10/1821 ae. -----  
 234, " Penelope, w. of Nathaniel Jr., d. 5/29/1780, ae. 25yr. 10mo.  
 184, Wood Katilda, w. of Brewster H., d. 3/26/1845 ae. 55-5-26  
 185, " Brewster H., d. 4/18/1847 ae. 63-8-25  
 342, " Phebe, w. of John Wood, d. 10/3/1773 ae. 57yr.  
 343, " Martha, w. of John, " , d. 8/24/1798, ae. 64yr.  
 344, " John, d. 6/10/1801, ae. 90 yr.  
 427, " Elizabeth, w. of Silas, d. 12/17/1859, ae. 69-4-27  
 448, " SILAS, d. 3/2/1847 ae. 78 yr.  
 449, " infant son of SILAS & Elizabeth, d. 6/10/1832  
 450, " Israel, d. 5/8/1791, ae. 68yr.  
 451, " Vashti, w. of Israel, d. 4/22/1812, ae. 86yr.  
 275, Woodhull Julia, dau. Wm. & Elizabeth, d. 8/19/1798, ae. 1yr. 9Mo.  
 341, Woolsey Jane, w. of Henry, d. 10/20/1827, ae. 21yr. 9Mo.  
 341, " also infant daughter, ae. Ida.  
 345, " Nathan W., d. 5/2/1826, ae. 35 yr.  
 346, " Phebe, w. of Rev. James Demarest M.D., d. 1/24/1883 ae. 70 yr.  
 347, " Lettie, w. of Nathan W., d. 12/11/1862, ae. 71 yr.  
 459, Woolworth Alexander, of Suffield Conn., d. 9/19/1791 ae. 23 yr.



Broken and unset stones in Sec. # I, as of 1896  
when this list was first started.

Conklin, Esther, dau. Cornelia & Elizabeth, d. 10/11/1755 ae. 1-10-26  
" Benjamin, d. Nov.-- 1758, ae. 43 yr.  
" Eliakim, s. of Benj. & Hannah, d. 11/5/1758, ae. 18 yr.

Williams, Keziah, w. of Nathaniel, d. Sept.--17??, ae. 28 yr.

Wood, Mary, w. of Israel, dau. of Rev. Ebenezer Prime, d. 12/10/1756,  
ae. 25-2-19

Wood, ----, Aug. 1, ----, ae. 68yr.

Wood, Sarah, w. of Israel, d. 1/9/1751/2 ae. 25 yr.  
also her infant daughter.

Scudder, Moses, d. 5/28/1759 ae. 50 yr.

- 23, Bennett, Elizabeth<sup>wid</sup>, w. of Samuel, d. 2/22/1832 ae. 84 yr.  
 23, " Samuel, d. 10/10/1810 ae. 62 yr.  
 24, " Mary, d. 7/26/1822 ae. 42 yr.  
 112, " Naomi, b. 12/7/1753, d. 1/18/1863  
 113, " Israel, d. 7/7/1817 ae. 44-7-8  
 114, " Alexander, d. 2/19/1819, ae. 33 yr.  
 124, " Martha<sup>wid</sup>, w. of Timothy, d. 1/30/1850 ae. 93 yr.  
 125, " John, d. 1/21/1846 ae. 59 yr.  
 126, " Timothy, d. 11/21/1823, ae. 75 yr.  
 1, Brush, Elizabeth, w. of Zephania, d. 4/10/1818, ae. 34 yr.  
 2, " Edmund R., s. of Jesse & Marietta, d. 8/25/1845, ae. 1-2-5  
 3, " infant dau. of above, d. 2/23/1846, ae. 24 da.  
 6, " Maria Antionette, w. of Abiel, d. 1/13/1849, ae. 60 yr.  
 7, " Abiel, late of N. Y. C., d. 1/4/1836, ae. 48 yr.  
 8, " Tredwell, d. 2/18/1826, ae. 71 yr. 7 mo.  
 9, " Isaac, d. 3/17/1825, ae. 46 yr.  
 16, " Mary, dau. Elkanah & Phebe, d. 6/11/1823, ae. 52 yr.  
 17, " Elkanah, d. 6/2/183, ae. 52 yr.  
 18, " Phebe, w. of Elkanah, d. 2/20/1848, ae. 70-11-20  
 19, " Jane M. dau. Elkanah & Phebe, d. 11/20/1846, ae. 33-5-10  
 45, " Annie<sup>dau</sup>, w. of Tredwell, d. 4/24/1800  
 68, " JESSE, (Kaj.) d. 7/12/1800, ae. 48 yr.  
 69, " Dorothy, w. of Jesse, d. 12/16/ 1835 ae. 84 yr. 5 mo.  
 41, Bumpstead, Ruth, w. of Thomas, d. 4/6/1833, ae. 34 yr.  
 13, Bunce, Elizabeth, w. of Joel, d. 12/30/1890, ae. 75 yr.  
 14, " Joel, d. 4/29/1853, ae. 37 yr.  
 15, " Emma, dau of two above, d. 11/18/1842, ae. 2 mo. 18 da.  
 55, Coddington, Mary, w. of Benj., d. 2/17/1812, ae. 52 yr.  
 56, " Wm., d. 9/2/1827, ae. 31-4-18  
 25, Conklin, Sarah, w. of Erastus H., d. 11/23/1874, ae. 72 yr. 4 mo.  
 26, " Ruth, w. of above, d. 3/17/1834, ae. 45-3-21  
 27, " Erastus H., d. 9/27/1849 ae. 63 yr.  
 28, " Mary E. w. of Ansel, dau. Conklin & Ruth Gould, d. 9/24/1831, ae. 24 yr  
 29, " Ezra, d. 2/17/1815, ae. 53-3-17  
 30, " Sarah<sup>wid</sup>, w. of Ezra, d. 5/8/1819 ae. 64 yr.  
 31, " Rebecca, w. of Nathan W., d. 2/26/1822 ae. 28 yr.  
 32, " Henry, d. 9/22/1822, ae. 25 yr.  
 33, " Martha, w. of Samuel, d. 8/8/1822, ae. 53 yr.  
 50, " Ezekiel, d. 10/23/1820, ae. 80 yr. 11 mo.  
 51, " Mary<sup>wid</sup>, w. of above, d. 11/22/1804, ae. 66 yr.  
 57, " David, d. 12/3/1787, ae. 44 yr.  
 58, " Thomas, M., s. of Thomas & Phebe, d. 9/20/1829, ae. 4 yr. 8 mo.  
 59, " Sybil, w. of David, d. 8/15/1788 ae. 44 yr.  
 60, " Angeline, dau. Henry & Sabina, d. 3/19/1829 ae. 57yr.  
 100, " Peleg, d. 9/25/1839 ae. 62.  
 101, " Elizabeth, w. of Peleg, d. 3/25/1856, ae. 74-11-27  
 155, " Rebecca<sup>wid</sup>, w. of Hubbard, widow of Richard, d. 1/27/1793, ae. 62 yr.  
 156, " Richard, d. 7/24/1787, ae. 61 yr.

- 14
- 49, Dean, Samuel W. s. of John & Elizabeth, d. 8/19/1823, ae. 1yr. 7 mo.  
 94, Denton, Rebecca w. of Alexander, d. 5/2/1814, ae. 66 yr.  
 95, " Alexander, d. 4/24/1815 ae. 66yr. *SIGNED-ASSC.*  
 75, " Benjamin Franklin, s. Sam'l. & Mary A., d. 6/3/1854, ae. 7-II-25  
 76, " Caroline, w. of John V., d. 10/4/1842, ae. 42 yr.  
 77, " Samuel W., s. of Sam'l. & Hannah, d. 4/17/1847, ae. 24-I-9  
 78, " Mary Ann, w. of Sam'l. W., d. 7/22/1846 ae. 27-3-20  
 79, " Alexander, s. of Sam'l. & Hannah, d. 8/17/1839, ae. 22-9-8  
 97, " Benjamin, d. 5/12/1789, ae. 68 yr.  
 96, " Rebecca (Ketcham) w. of above, d. 5/23/1783, ae. 61 yr.  
 98, " Temperance, *nee* d. 1/9/1742/3, ae. 61 yr.  
 127, Filer, Rachael, w. of Alpheus, d. 3/13/1802, ae. 29 yr.  
 127, " also infant dau. -----  
 148, Fleet, Charles W., s. of Obadiah P. & Sarah d. 9/25/1824 ae. 3 yr. 9 mo.  
 164, " Sarah, d. 5/14/1878, ae. 88-3-25  
 167, " Simon, d. 12/1.1775, ae. 42 yr.  
 168, " Ruth (Sammis) w. to Stephen White, widow of Simon Fleet, 11/5/1795,  
 ae. 60 yr.  
 169, " Samuel W., s. of Samuel & Rachael d. 9/22/1798, ae. 3 mo. 27 da.  
 170, " Phebe, w. of Sam'l., d. 4/11/1799 ae. 34 yr.  
 171, " Joanna M. dau. Sam'l. & Eliza, d. 8/25/1813, ae. 3-9-19  
 172, " Eliza, w. of Sam'l. dau. John & Joanna Gardiner, d. 9/3/1813, ae. 37 yr  
 173, " Samuel, d. 12/22/1823, ae. 55 yr.  
 174, " Henry Meng, s. of Sam'l. & Rachael, d. 8/27/1827 ae. 35 yr. 10 mo.  
 11, Gould, Wm., d. 5/6/1859, ae. 89-2-21  
 12, " Sarah, w. of Wm. d. 1/1860, ae. 87-3-1  
 46, " Keturah, w. of Wm., d. 12/14/1800, ae. 32 yr.  
 52, " Experience, w. of Abiel, dau. Capt. Jonathan Titus, D. 4/21/1846, ae. 7  
 53, " Abiel, d. 3/6/1837, ae. 72 yr.  
 54, " Mary, w. of Abiel, d. 12/11/1812, ae. 47 yr.  
 89, " Phebe E., dau. Jesse & Elizabeth, d. 9/30/1849, ae. 23 da.  
 90, " Alfred, s. of above, d. 2/10/1858, ae. 22 yr.  
 91, " Elizabeth, w. of Jesse, d. 10/7/1853, ae. 60 yr.  
 92, " Benjamin, d. 8/11/1845, ae. 87 yr.  
 93, " Elizabeth, w. of Benj., d. 10/22/1817, ae. 63 yr.  
 205, " Walter, d. 4/2/1828, ae. 80 yr.  
 206, " Anna, w. of Walter, d. 2/12/1847  
 207, " Brewster, d. 7/13/1853, ae. 43 yr.  
 208, " Henry B., s. of Brewster & Elizabeth, d. 11/23/1856 ae. 18 yr.  
 209, " Anna K., dau. of above, d. 1/12/1860, ae. 15 yr.  
 34, Higbie, Clarissa, w. of Daniel B., d. 4/2/1812, ae. 23 yr.  
 34, " also her s. ae. 3 da.  
 121, Hopper, Mary, w. of Mathew, d. 4/9/1780, ae. 40 yr.  
 122, Huggins, Wm., d. 7/14/1790, ae. 50 yr.  
 137, Jarvis, Augustine, d. 11/6/1843, ae. 82 yr.  
 136, " Martha w. of above, d. 9/13/1815, ae. 51-5-6  
 163, " Philip, d. 9/27/1786, ae. 63 yr. *SIGNED-ASSC.*  
 162, " Elizabeth, *nee* w. of Philip, d. 6/21/1807, ae. 79 Yr.  
 66, Jones, Obadiah, Esq., d. Dec. 1790, ae. 75 yr.  
 181 Jarvis, Elizabeth, w. of Israel Jarvis, dau. Joel & Elizabeth Smith,  
 born 3/7/1776, d. 10/30/1810  
 ( see SMITH list)



- 45, Ketcham, Mary E., dau. Stephen & Mary, d. 2/23/1838, ae. 4-3-22  
 46, " John P., s. of above, d. 2/28/1823, ae. ----  
 47, " Stephen, d. 5/13/1840, ae. 45 yr.  
 48, " Mary Dexter, w. of above, d. 10/9/1887 ae. 87 yr.  
 226, Lockwood, Emery, d. 7/29/1838, ae. 27-II-17  
 80, Macavey, John, d. 1/28/1811, ae. 35 yr.  
 152, Mather, George B., s. Alexander & Prudence, d. 8/22/1811, ae. 1\*1\*9  
 154, " Jemima, w. of Alexander, d. 4/5/1803, ae. 44 yr.  
 118, Mead, Emma, dau. dau. Henry & Amelia, d. 7/1/1839 ae. 1-5-19  
 116, Meredith, Maria Louisa, dau. Hannah & Wm., d. 8/14/1829, ae. 10 mo.  
 117, " Elizabeth, d. 2/18/1835, ae. 4-5-22 children of  
 117, " Wm. Henry, d. 5/25/1835, ae. 2-II-22 Wm. & Hannah  
 129, Morgan, James, s. of John & Abigail, d. 4/21/1845, ae. 82 yr.  
 130, " Abigail, w. of John, d. 3/30/1769 ae. 36 yr.  
 131, " John, d. 8/10/1787, ae. 56 yr. (Rev. Patriot)  
 131, " Ebenezer, s. of above, d. on the coast of Africa, 3/5/1770, ae. 19 yr.  
 131, " also Rebecca Legate, dau. John, d. 1780, ae. 22 da.  
 146, Oakley, Mary Louisa, dau. John W. & Keturah, d. 5/9/1836, ae. 2 yr. 8 mo.  
 147, Antionette, dau. of above, d. 10/11/1846, ae. 19-I-8  
 147, also, Charles Egbert, d. at Vera Cruz, 4/12/1847, ae. 21-5-22  
 4, Place, Ruth, w. of Joseph, d. 10/13/1856, ae. 75-4-5  
 5, " Joseph, d. 4/21/1839 ae. 62 yr. 5 mo.  
 115, " John, s. of John & Charity, d. 9/6/1815, ae. 1mo. Ida.  
 149, " John (Capt.) d. 6/8/1839, ae. 66 yr.  
 150, " Charity, w. of above, d. 10/1/1849 ae. 77 yr.  
 175, " Ephraim, d. 4/13/1833 ae. 34-5-26  
 195, " Edna, w. of above, d. 1/22/1839, ae. 41-II-15  
 196, Please, Maria, dau. of Morris & Mary, d. 2/8/1817, ae. 21 yr.  
 197, " Mary, w. of Morris, d. 6/8/1849, ae. 72-7-18 (spelled Pleace)  
 198, " Morris, d. 9/17/1815, ae. 44 yr.  
 199, " Juliann, dau. of above, d. 1/2/1815, ae. 11 mo.  
 200, " Anner, w. of Wm. d. 3/21/1800, ae. 67 yr.  
 201, " Wm., d. 8/17/1827, ae. 90 Yr.  
 135, Platt, Sarah, w. of Amos, d. 1/15/1796, ae. 82 yr.  
 153, " Sarah, w. of Isaac, d. 10/3/1809, ae. 20-5-2  
 73, Potter, Saraphina, dau. Gilbert & Elizabeth, d. 12/21/1782 ae. 15 yr.  
 (buried here at time British had fort on family plot.)  
 214, " Peleg, s. of Gilbert & Elizabeth, d. 4/5/1764, in. 13 yr.  
 215, " Peleg, d. 2/27/1751 ae. 9 mo.  
 216, " Elizabeth, dau. of above, d. 6/17/1759, ae. 1-7-17  
 217, " GILBERT, (Col.) (M. D.) d. 2/14/1786 ae. 61 yr. (b. 1/8/1725)  
 218, " Elizabeth, w. of above, d. 11/17/1811, ae. 83-8-8  
 220, " NATHANIEL, d. 11/24/1841, in 80th. yr. (b. 12-23-1761)  
 unmarried, Patriot & Refugee of Rev. also war of 1812.  
 19, Rogers, Isaac, d. 6/25/1831, ae. 68 yr. 10 mo.  
 20, " Hannah, w. of above, d. 10/26/1842 in 80th. yr.  
 22, " Abel, d. 12/13/1840, ae. 71 yr. 4 mo.  
 21, " Mary, w. of above, d. 5/5/1847, ae. 74 yr. 29 da.  
 102, " Phebe, w. of Obadiah, d. 11/12/1754, in ye 69 yr.  
 103, " Obadiah, d. 2/7/1759, in ye 81 yr.

- I04, Rogers, Obadiah d. 8/10/1770, ae. 43 yr.  
 I06, " Hezekiah, d. 9/25/1778 ae 75 yr.  
 I05, " Ruth, <sup>sc. 80%</sup> W. of above, d. 3/2/1786, ae. 82 yr.  
 I08, " Alexander, d. 7/20/1784, ae. 43 yr.  
 I07, " Hannah, w. of above, d. 7/30/1784, ae. 40 yr.  
 I09, " Platt, d. 5/26/1812 ae. 45 yr.  
 III, " Zebulon, d. 3/4/1820 ae. 58 yr.  
 I10, " Rhoda, <sup>sc. 80%</sup> W. of above, d. 2/24/1835 ae. 72 yr.  
 I19, " Obadiah, d. 10/27/1830, ae. 53 yr. 9 da.  
 I27, " Ananias, d. 2/16/1775 ae. 64 yr.  
 I32, " Richard, s. of Sephaniah & Rebecca, d. 2/21/1828, ae. 30 yr. 1 mo.  
 I33, " Joshua, d. 6/1/1785, ae. 47 yr. 7 mo.  
 I34, " Hannah(Smith), w. of Joshua, d. 12/18/1787 ae. 48 yr.  
 219, " Sarah, w. of Wm., dau of ~~Wm.~~ GILBERT POTTER, d. 4/13/1823, ae. 67 yr  
 219, " Wm. b. 11/19/1741, lost in storm, Oct 12 1780, L.I. Sound.  
 219, " Ruth, b. 8/1/1758, drowned L. I. Sound, 9/8/1780  
 I44, Sammis, Mary Catherine, dau. Oliver & Sarah, d. 10/23/1820, ae. 8-5-21  
 I45, " Oliver, d. 12/11/1831, ae. 47-5-24  
 I65, " Jacob, d. 10/4/1819, ae. 28 yr.  
 I66, " Brewster K., s. of Jacob & Phebe, d. 11/18/1819 ae. 11 mo. 17 da.  
 I82, " Jacob, d. 8/2/1822, ae. 29 yr.  
 I83, " John, d. 4/21/1831 ae. 39 yr. 5 mo.  
 I84, " Stephen, d. 9/12/1804, ae. 39 yr. 20 da.  
 I85, " Ruth, w. of Silas, d. 4/5/1811, ae. 76 yr. (b. 6-25-1735)  
 I86, " Abigail, dau. David & Sarah, d. 8/2/1751, ae. 27 yr.  
 I87, " Silas, d. 4/7/1803, ae. 71-6-23  
 I88, " Ruth, w. of Silas, d. 2/27/1780 ae. 77 yr.  
 I89, " Silas, d. 6/1/1779, ae. 79 yr.  
 I90, " Phebe, dau. Silas & Ruth, d. 12/2/1766, ae. 21 yr.  
 I91, " Mary, dau. of above, d. 3/28/1769 ae. 21 yr.  
 I92, " Sarah, dau. Alexander & Amy, d. 8/17/1793, ae. 1 mo. 10 da.  
 I93, " Henry, s. of above, d. 9/8/1792 ae. 9 mo. 3 da.  
 I94, " Clarissa, dau. Stephen & Anna, d. 10/25/1791, ae. 4-5-25  
 ---- " Mary, dau. Smith & Mary, d. (Jan. or May) 11, 1844, in 18th yr.  
 ---- " Mary, w. of Smith, dau. Isaac & Hannah Rogers, d. 5/11/1824, ae. 38 yrs.  
 210, " Ebenezer G., d. 8/24/1821, ae. 25 yr. 6 mo.  
 212, " Alexander, d. 7/10/1809, ae 66 yr.  
 211, " Amy, w. of above d. 10/30/1838, ae. 77 yr.  
 213, " Ann, widow of Stephen (w. of John Lefferts) d. 5/2/1844, ae. 77 yr.  
 221, " Ruth, w. of George D., d. 8/28/1866, ae. 78-10-15  
 222, " George, d. 9/2/1825 ae. 40-4-7  
 223, " Phebe, dau David & Sarah, d. 7/4/1739, ae. 22 yr.  
 224, " Sarah, w. of David, d. 5/27/1739  
 71 Scudder, Jacob, d. 1/25/1795, ae. 32 yr.  
 72, " Hannah, w. of above, d. 8/28/1790 ae. 21 yr.  
 I51, Smith, W. S., d. 3/3/1835, ae. 24-3-14  
 I57, " Zadoc, s. of Jonathan & Elizabeth, d. 2/16/1806, ae. 26 da.  
 I81, " Elizabeth, dau of Joel & Elizabeth, d. 10/30/1810 (b. 3/7/1776)  
 61, Titus, Israel, d. 8/15/1811, ae. 67 yr. 6 mo.  
 62, " Elizabeth, dau. Israel & Temperance, d. 5/1/1807, ae. 28 yr.



17

63, Titus, Temperence(Norton), w. of Israel, d. 10/26/1789, ae. 47 yr.  
 64, " Polly, dau. Israel & Temperence, d. 9/1/1796, ae. 19-5-17  
 65, " James, s. of above, d. 5/12/1793 in 9th. yr. ALL  
     Ira, s. of above, d. 5/13/1793 in 11th yr. DIED  
     Clary, dau. of above, d. 5/19/1793 in 13th yr. ONE WEEK  
 81, " Phebe, w. of Henry, d. 1/15/1846, ae. 92 yr.  
 82, " Henry, d. 7/27/1816, ae. 64 yr.  
 83, " Sarah, w. of Jonathan, d. 12/15/1813, ae. 88 yr.  
 84, " Jonathan(Capt), d. 6/12/1808, ae. 85 yr. (Patriot)  
 85, " John Capt), d. 6/4/1754, ae. 69 yr.  
 86, " Sarah, w. of John, d. 3/6/1740/1, ae 47 yr.  
 87, " John Jr., d. Jan. 1751, ae. ----  
 88, " Henry, d. 9/4/1754, ae. 31 yr.  
 120, " Ruth, w. of Jacob, d. 10/12/1849, ae. 90 yr.  
 128, " Jacob, d. 3/11/1832, ae. 71-4-24  
 158, " Timothy, d. 10/8/1735, ae. 28 yr.  
 159, " Abiel(3rd.), d. 5/3/1759, ae. 50 yr.  
 160, " Elizabeth, w. of above, d. 2/10/1750/1, ae. 41 yr.  
 161, " Abiel, s. of Abiel, d. 6/6/1760 in ye 5th. yr.  
 138, Wetmore, Apollos R., s. of Noah & Winfred, ae. 3-9-25, d. 1/10/1790  
 139, " Winfred, w. of Noah, d. 4/11/1815, ae. 46 yr. 5 mo.  
 140, " Wm. Walter, s. of Apollos & Polly, d 8/24/1812, ae. 14.mo. 11 da.  
 38, Willetts, Amos, P., s. of Platt & Phebe, d. 3/4/1812, ae. 1-10-25  
 39, " Mary, dau. of above, d. 3/9/1810, ae. 1-7-12  
 40, " Keziah, dau. Amos & Mary, d. 2/3/1801, ae. 13 yr.  
 40, " Mary, dau. of above, ae. five da. d. 4/29/1797  
 42, " Mary, w. of Amos, d. 6/22/1811, ae. 50 yr.  
 43, " Amos, d. 4/16/1799 ae. 43 yr.  
 44, " Rhoda, w. of Platt, d. 4/7/1827, ae. 40 yr.  
 10, Williams, Wm. E., d. 2/5/1836, ae. 27-8-14  
 10, " Keturah, w. of above, dau. Wm. & Sarah Gould, d. 4/26/1836, ae. 32-8-2  
 10, " infant dau. of above, d. 7/30/1836, ae. 3 mo. 21 da.  
 176, " Gilbert, d. 1/26/1809, ae. 45 yr. 1 mo.  
 177, " Martha, w. of above, d. 6/12/1813, in 49th yr.  
 173, " Mary H., d. 3/12/1841, ae. 20 yr. 3 mo.  
 179, " Sarah E., d. 5/8/1853, ae. 50-9-12  
 ---- " Keziah(Brush), married Nathaniel 4/30/1741, d. Sept 17--, ae. 28 yr.  
 180, " Henry, b. 4/8/1790, d. 8/4/1864  
 180, " Harriet D., w. of above, b. 8/28/1816, d. 8/29/1849  
 202, " Mary, dau. Nathaniel & Elizabeth, d. 4/30/1734, in ye 10th yr.  
 203, " Elizabeth(Platt), w. of above, d. 12/26/1773, ae. 79 yr.  
 204, " Nathaniel, d. 8/4/1732, ae. 34 yr.  
 225, " Hannah, dau. Nathaniel & Penelope, d. 4/12/1779, ae. 4 mo.  
 168, White, Ruth(Sammis), w. of Stephen White, b. 1735/6, d. 11/5/1795

Broken & unset Stones as of 1896,

Lysaght, Martha, w. of James, died Jan, ----  
 Titus, Abiel 4th, ----  
 Wickes, Jonathan, ----



- 177, Aproy, Susan R. w. of Francis, dau. John B. & Rebecca Lewis,  
 b. 6/3/1843, d. 7/26/1893  
 176, " Isabella L. w. of Francis, dau John & Rebecca Lewis,  
 b. 12/2/1845, d. 1/12/1912  
 --- Burr, Sarah, E, 1842-1924 - same stone  
 --- Burr, Hannah A, 1856-1936 - same stone  
 180, Barrett, Oliver, d. 4/29/1850, ae. 72 yr. 19 da.  
 181, " Clarissa w. of above, d. 5/19/1884 ae 87 yr. 6 mo  
 130, Bennett, Rulof D., d. 8/14/1854 ae. 68 yr.  
 131, " Elizabeth, w. of above, d. 4/29/1848, ae. 54 yr.  
 127, Brown, Margaret, w. Rev Brown, d. 1/19/1749/50, ae. --- DAU. - REV. PRIME.  
 164, " w. of Dr. Oliver Brown, b. 10/4/1779, d. 9/22/1855 Mary,  
 165, " Rev. Oliver E., b. 12/3/1812, d. 7/26/1857  
 166, " Oliver M. D., b. 3/10/1769, d. 10/30/1815  
 67, Brush, John Esq, d. 11/5/1795 ae. 69 yr.  
 68, " Phebe, dau. John & Hannah, d. 6/3/1768, ae. 21 yr. 4 mo.  
 69, " Samuel s. of above, d. 6/26/1781, ae 21 yr. 11 mp.  
 70, " Hannah, w. of John, d. 11/21/1789, ae. 54 yr. 2 mo.  
 75, " Ichabod, d. aug. 1809, ae. 45 yr.  
 76, " Jesse, d. 2/21/1815, ae. 40 yr.  
 76, " Mary, dau of above, d. April, 1816, ae. 3 yr.  
 77, " John, d. 1/21/1828, ae. 56-5-25  
 78, " Naomi, w. of John, d. 5/27/1833, ae. 62-6-15  
 79, " Wealthy Ann, dau. John & Naomi, ae. 22-8-19, d. 1/29/1833  
 81, " George C., d. 3/11/1850, ae. 33 yr.  
 153, " Experience, dau. Nathaniel & Hannah, d. 8/29/1793, in 18th yr.  
 162, Conklin, Ezra, d. 11/30/1838 ae. 41-9-12  
 163, " Jane A., w. of above, b. 12/28/1805, d. 5/14/1889  
 179, Calvert, Helen M., dau. Wm. H. & Hanna A., d. 9/13/1843, ae. 1 yr. 22 da  
 83, Davis, Mathias, d. 12/12/1849, ae 88 yr.  
 84, " Frances, w. of above, d. 4/20/1831, ae. 65 yr. 4 mo.  
 85, " Frances H., dau of above, d. 5/29/1828, ae. 34-9-9  
 182, DeLong, Ira, s. of Jacob & Nachael, d. 8/3/1851, ae. 5-6-19  
 183, " Edmond, s. of above, d. 8/27/1851, ae. 10-9-19  
 4, Fleet, Deborah, w. of Simon, d. year 1723, ae. 19 yr.  
 160, Gould, Mary Augusta, dau. Ebenezer & Matilda W., d. 11/25/1838, ae. 3-5-3  
 161, " Charles A., infant son of Conklin & Ruth, d. 12/13/1827, ae. 8 mo.  
 86, Hendrickson, John C. s. of Nathaniel & Maria, d. 7/18/1850, ae. 37 yr. 9 da.  
 35, Ireland, Abigail, w. of Albert, d. 9/10/1854, in 46th yr.  
 59, Jacobin, Anne, born in Germany, d. 2/15/1831, in 22nd. yr.  
 --- Johnson, Elizabeth, w. of Ruben, died Sept. 20, 17--  
 41, Ketcham, Catherine, w. of Conklin, d. 5/6/1827, ae 30 yr.  
 41, " Conklin, s. of Solomon & Rebecca, lost at sea, 12/16/1821, ae. 27 yr.  
 42, " Rebecca, w. of Solomon, d. 2/9/1874 ae. 78 yr.  
 43, " Capt. Solomon, d. 3/28/1852, ae. 67-3-16  
 44, " Wm. D., s. of Solomon & Rebecca, d. 7/19/1830, ae. 14 yr. 20 da.  
 45, " Alfred, s. of above, d. 11/13/1890, ae. 19 yr. 29 da.  
 46, " infant son of above d. 6/8/1815, ae 15 da.  
 47, " Oliver, s. of Jonas & Amelia, d. 8/19/1810, ae. 9 yr.  
 48, " infant dau. of above, d. 7/27/1806, ae. 16 da.  
 49, " infant son of above, d. 5/25/1805, ae 2 mo.  
 50, " Oliver, s. of Solomon & Rebecca, d. 8/5/1792, ae. 3 yr. 10 mo.

- 51, Ketcham, Daniel, d. 10/19/1778 ae. 23 yr.  
 52, " John, s. of Solomon & Hannah, killed by cart-wheel 1/1/1773, ae. 10 yr.  
 53, " Platt, d. 9/25/1800, ae. 31-5-10  
 54, " Mr. Solomon, d. 9/21/1781, ae. 58 yr.  
 55, " Hannah(Conklin), w. of above, d. 3/3/1784, ae. 56 yr.  
 56, " Rebecca(Platt), w. of Solomon, 4/17/1834 ae. 78 yr.  
 57, " Solomon(2nd.), d. 2/19/1851, ae. 93-10-13 PRISONER OF WAR.  
 58, " Jonas, s. of above, d. 10/31/1842, ae. 63 yr.  
 58, " memory of infant son of Jonas & Rebecca, buried, N. Y. ae. 1 mo.  
 139, " Mary, dau. of Philip & Phebe, d. 5/11/1750 ae. 21 yr.  
 140, " Phebe, w. of Philip, d. 2/10/1737/8, ae. 47 yr.  
 141, " Philip, d. 1/5/1770, ae. 79 yr.  
 174, " Abiel, d. 1/14/1885, ae. 84 yr. both died  
 174, " Sarah, w. of above, d. 1/14/1885, ae. 82 yr. same day in fire.  
 175, " George W., s. of above, d. 6/23/1835 ae. 7-3-12  
 176, " child of " date, -----  
 113, Lattin, Sarah, E., d. 5/7/1836 ae. 2 yr. 11 mo. children of  
 113, " Andrew J., d. 3/25/1836, ae. 9 mo. 14 da. Wm. & Phebe. Lattin.  
 113, " Mary L., d. 3/19/1850, ae. 9mo. 14 da.  
 114, " Sarah A., w. of Jarvis, d. 12/3/1854, ae. 25-3-6  
 115, " Jarvis, D., d. 12/3/1851, ae. 25 yr.  
 115, " s. of above, d. 3/5/1852 ae. 4 mo. 4 da.  
 116, " Wm. d. 4/25/1862, ae. 58 yr.  
 153, Lewis, Mary Ann, w. of Henry, d. 7/25/1845, ae. 49 yr.  
 159, " Henry S., s. of above, d. 2/11/1854, ae. 34 yr. 2 mo.  
 179, " John B., d. 7/13/1848, ae. 52 yr.  
 169, Loose, Isaac, d. 3/26/1825, ae. 84-5-13  
 168, " Ruth(Taylor), w. of above, d. 3/7/1811 ae. 67 yr.  
 177, " Sarah, d. 8/22/1858, ae. 84 yr.  
 7, Lewis, Sarah, w. of Joseph S., dau. of Gilbert & Abigail Scudder,  
 d. 2/6/1887, ae. 91-2-19  
 --- " Charles Henry, s. of Henry S. & Abigail U., b. 12/10/1821, d. 3/14/1897  
 --- " Charlotte Merritt, w. of above, b. 6/11/1856, d. 8/7/1944  
 132, Patten, Thomas, b. in Boston 12/21/1810, d. 2/17/1891  
 133, " Charlotte, w. of above, dau. Isaac & Freelove Scudder, d. 6/1/1871, ae. 58  
 2, Place, Naomi, w. of Oliver, d. 12/14/1823, ae. 44 yr.  
 3, " Ann Maria, dau of above, d. 10/2/1821, ae. 4-1-21  
 88, Platt, F. Zophar, d. 9/23/1792, ae. 87 yr.  
 89, " Rebecca, w. of above, d. 4/5/1782, ae. 67 yr. 2 2  
 90, Egbert, s. of Ebenezer & Abigail, d. 9/30/1793, ae. (5)(7) mo.  
 91, Naomi Adeline, dau of above, d. 9/13/1798 ae. 13 mo. 23 da.  
 94, Ebenezer, d. 6/26/1839, ae. 85 yr.  
 93, Abigail, w. of above, d. 5/14/1828, ae. 68 yr.  
 105, illegible in 1896, stones used by British.  
 104, same.  
 106, Hannah, dau. of Dr. Zophar & Rebecca, d. 9/26/1752, ae. 12 yr.  
 107, David, d. 1/19/1766, ae. 22 yr.  
 108, Elizabeth, dau. Zophar & Elizabeth, d. in N.Y., 3/23/1821, ae. 3-6-18  
 110, Gertrude, dau of above, d. 6/11/1857, ae. 35 yr.  
 109, Zophar, d. 6/22/1828, ae. 44 yr.



- III, Platt, Elizabeth, w. of Zophar, d. 2/8/1866, ae. 81 yr.  
 128, " Jeremiah, d. 10/16/1754, ae. 68 yr.  
 149, " Hannah, w. of Silas, d. 1/14/1821, ae. 57-1-9  
 150, " Olive, dau of above, d. 5/21/1810, ae. 26-4-26  
 151, " Silas, d. 5/21/1808, ae. 47-11-16  
 152, " Obadiah, s. of Silas & Hannah, d. 7/29/1805, ae. 6-8-15  
 154, " Sally, dau. Gilbert Phebe, d. 11/4/1787, ae. 2-1-27  
 155, " Mary, w. of Obadiah, d. 1/19/1793, ae. 64 yr. (dau. Ananias Carll)  
 156, " Phebe, w. of Gilbert, d. 5/19/1833, ae. 73 yr.  
 157, " Gilbert, d. 1/26/1835, ae. 77 yr.  
 28, Pierce, John C., s. of Abraham & Harriet, d. 8/5/1818 ae. 1-3-19  
 99, Prime, Theodore Frelinghuysen, s. of Edward Y. & Emma, d. 7/27/1846, ae. 1-6-8  
 100, " Edward Youngs, d. 1/15/1869, ae. 60-1-3  
 101, " Emma, w. of above, d. 4/14/1886, ae. 73-2-19  
 102, " Edward Payson, d. at New Orleans, 10/4/1862, ae. 23-9-5, (9th. Conn. Vol.)  
 102, " Henry Clay, d. killed at Cedar Mt. Va. 8/9/1862, ae. 19-4-28 both sons  
 of Edward-Emma  
 102, " Wm. Cowper, s. Edward & Emma, d. 9/30/1901, ae. 65-11-26, vet. Civil war.  
 112, " Rev. Ebenezer, 9/25/1779 ae. 79 yr.  
 124, " Sarah, dau above & Experience, b. 9/15/1732, d. 12/12/1732  
 125, " Hannah, b. at Milford, d. 10/3/1736, ae. 26 yr.  
 126, " Experience, w. of Rev. E., b. Southold, 11/6/1699, d. 1/1/1734 (Huntingto  
 129, " Ebenezer Jr. d. 10/20/1742, ae. 18-11-26  
 143, " Margaret Brown, dau. Ebenezer & Experience, b. 5/22/1825, d. 6/8/1845  
 144, " Matilda, d. 1/18/1813 ae. 7 yr. (dau. of  
 144, " Marietta, d. 1/20/1808 ae. 2 mo. (Ebenezer & Experience)  
 145, " Benjamin Y. (M.D.) d. 10/31/1791, ae. 58 yr. (was-wheel-right)  
 146, " Mary, w. of above, d. 3/7/1835 ae. 91 yr.  
 147, " Ann (Wheelright), dau of above two, d. 9/18/1813, ae. 33 yr.  
 no record of Prime's 1st. wife, (Margaret Sylvester)  
 1, Rogers, Mariam, dau. Wm. & Eliza Place, w. of Henry A., d. 4/17/1883, ae. 56 y  
 92, " Sarah Ogden, w. of Warren, d. in N.Y., 4/16/1820, ae. 38 yr.  
 95, " Warren, d. at N.Y., 2/3/1843, ae. 65 yr.  
 96, " Sidney P., d. at Brooklyn, 4/19/1858 ae. 40 yr.  
 97, " Theodore, d. at Bklyn., 6/16/1871, ae. 62 yr.  
 98, " Harriet, w. of above, b. 3/12/1806, d. 7/7/1880  
 117, " Hannah, w. of Israel, d. 10/26/1843, ae. 52-10-1 (2nd.)  
 120, " Hannah, w. of Israel, d. 4/13/1808, ae. 27 yr. (1st.)  
 121, " Israel, d. 10/28/1828, ae. 45-6-7  
 15, Sammis, David, died 1753, ae. 45 yr. 2nd.  
 19, " David, died 1751 1st.  
 5, Scudder, Sally Maria, Dau. Nathaniel & Elizabeth, d. 7/4/1826 ae 35 yr.  
 6, " Phebe, dau. Gilbert & Abigail, d. 2/15/1888, ae. 78-11-5  
 7, " Sarah, dau. above, w. Jos. S. Lewis, d. 2/6/1887, ae. 91-2-19  
 9, " Gilbert, d. 9/12/1855 ae. 91 yr. (Grandfather, Chas. R. Street)  
 10, " Abigail (Buffet), w. of above, d. 12/5/1840 ae. 76 yr.  
 11, " Rhoda (Jarvis), w. of Isiah, d. 5/17/1844, ae. 51 yr.  
 12, " Isiah d. 2/16/1875, ae. 84.  
 13, " Mary C. dau. Henry G. & Elenor C., d. 7/30/1853, ae. 13 mo.  
 14, " Elenor C. (Murray), w. of Henry G., d. 6/24/1858, ae. 36 yr.  
 15, " Henry G. s. Isiah & Rhoda, d. 1/26/1886, ae. 68 yr. 8 mo.  
 16, " Annie C. w. of Henry G., d. 4/16/1884, ae. 62-11-21  
 17, " Elizabeth & Victor, infant children of Henry G. & Annie C. date,-----  
 29, " Margaret, w. of Thomas, d. 7/23/1875, ae. 79-9-17  
 30, " s. of above, died at birth, 12/22/1826  
 30, " s. of above d. 3/11/1832



- 21 Scudder, John, s. of Nathaniel & Elizabeth, d. 2/20/1809 ae. 21  
 32, " Harriet H., w. of Henry G. b. 11/11/1840, d. 4/5/1893  
 35, " Wm. Murray, s. of above, d. St. Augustine Fla., 3/30/1881 ae. 30 yr.  
 63, " Charles F. s. Samuel & Letitia, d. 9/7/1832, ae. 7 mo. 19 da.  
 80, " Elenor, dau. Solomon & Francis F., d. 8/1/1848 ae. 21 yr.  
 33, " In honor of Henry G., d. Middletown N. J., 10/13/1929, b. 11/9/1856  
 134, " Freelove (Carl), w. of Isaac, d. 2/19/1857, ae. 66 yr.  
 135, " Isaac, d. 11/5/1842, ae. 55 yr.  
 136, " Jemima, w. Moses, d. 11/29/1821, ae. 63 yr. 6 mo.  
 137, " Moses, d. 11/2/1825, ae. 64 yr. 8 mo.  
 8 Street, Naomi, w. Shallom B., dau. Gilbert & Abigail Scudder, d. 7/12/1881  
 b. 4/2/1802  
 20, Smith, Elizabeth, w. Epenetus, d. 2/9/1858 ae. 87 yr.  
 21, " Epenetus, d. 5/24/1830 ae. 64 yr.  
 22, " Ezra B., s. of two above, d. 12/2/1826, ae. 26 yr.  
 23, " Treadwell, s. of Ist. two, d. 4/8/1830, ae. 27 yr.  
 24, " Zachariah, d. 4/4/1829, ae. 76 yr.  
 25, " Anna, w. of above, d. 3/26/1799 ae. 42 yr.  
 26, " Bebecca, dau. of two above, d. 9/1/1788 ae. 2 yr. 26 da.  
 27, " Lydia, w. of Zacharia, d. 9/17/1830 ae. 78-10-13  
 34, " Henry, d. 8/24/1802 ae. 74 yr.  
 36, " Rebecca, w. of Eliphalet, d. 9/18/1853 ae. 71 yr.  
 37, " Eliphalet, d. 12/14/1849, ae. 76 yr.  
 38, " Abigail, w. of Eliphalet, d. 1/27/1807 ae. 26 yr.  
 39, " Phebe N., w. of " d. 11/11/1812, ae. 26 yr.  
 40, " Eliza, w. of Charles, d. 1/10/1831, ae. 26-3-23  
 41, " Charles, d. 8/18/1841, ae. 36-11-4  
 60, " Seabury, s. of Enoch & Hannah, d. 12/22/1838, ae. 27-1-21  
 61, " Hannah, w. of Enoch, d. 6/18/1848, ae. 64-5-25  
 62, " Enoch, d. 3/3/1858, ae. 82 yr.  
 138, " Emma M. dau. Daniel E. & Grace A. d. 10/6/1847, ae. 1 mo. 14 da.  
 82, Walker, Eleanor, w. of Washington, b. 1/18/1802, d. 6/30/1867  
 103, Warner, Hannah, w. of Isaac, d. 12/31/1841 ae. 36 yr.  
 87, Weeks, Joshua, d. 4/17/1841, ae. 63 yr.  
 118, Wheeler, Obadiah, d. 2/3/1822, ae. 63 yr.  
 119, " Elizabeth, w. of above, d. 9/4/1822, ae. 47 yr.  
 122, " Wm. Edgar, s. of Thomas & Sophia R., d. 7/27/1843, ae. 6-2-18  
 123, " Henry M., d. 8/27/1852, ae. 42 yr.  
 71, Wickes, Jemima, w. of Eliphalet Esq., d. 11/3/1776, ae. 68 yr.  
 72, " Eliphalet, esq., d. 6/30/1761, ae. 54 yr.  
 73, " Thomas Jr. s. of Thomas (Capt), d. 12/20/1749, ae. 46 yr.  
 74, " Thomas (Capt), d. 10/24/1749, ae. 74 yr.  
 173, # Almy Jane, dau. George & Phebe E., d. 2/16/1854, ae. 1-3-14  
 169, Wiggins, Phebe, w. of Dr. Daniel, d. 12/13/1818 ae. 79 yr.  
 170, " John Sloss, s. of above two, d. 8/11/1775, ae. 5 yr.  
 171, " Walter, s. of above two, d. 8/25/1775, ae. 1 yr. 7 mo.  
 172, " Pene Wood, dau. of above two, d. 9/29/1776, ae. 9 mo.

Section 3

21

I48, Woolsey, Maria Matilda, d. 6/7/1846, ae. 5-9-23 children of  
I48, " N. Woodhull, d. 6/13/1846, ae. 2 yr. 4 mo. Wm. S. & Sarah C.  
I42, Youngs, Phebe, dau. Geo. & Phebe, d. 1/26/1752, ae. 3-10-18

Broken & unset Stones,  
sec. 3

Johnson, Elizabeth, w. of Ruben, d. 9/29/1758

- 135, Bayles, Phebe, w. of John, d. 6-11-1816, ae. 81-3-20  
 137, " Nancy, d. 2/26/1826 ae. 62 yr. 7 mo.  
 148, Baylis, John S. s. of John & Mehetable, d. 4/4/1856, ae. 24-7-15  
 149, " John S., d. 7/26/1837 ae. 66 yr.  
 150, " Mehetable, w. of John S., d. 1/14/1881 ae. 83-10-4  
 168, Bedell, Michael, d. 6/17/1810, ae. 68 yr.  
 168, " Esther, w. of above, d. 9/15/1789, ae. 40 yr.  
 169, " Richard, d. 5/10/1854, ae. 70-2-25  
 170, " Daniel, d. 3/12/1813, ae. 31 yr.  
 1, Buffett, Sarah, w. of Jesse, d. 9/29/1805, ae. 69 yr.  
 2, " Jesse, d. 3/7/1814, ae. 77 yr.  
 108, Bunce, Jacob, d. 4/23/1741, ae. 31 yr.  
 --- BAYLIS, Phebe Amelia, b. 2/8/1826, d. 4/8/1908  
 --- " Ann Elizabeth, b. 4/9/1833, d. 11/9/1913  
 9, Carlisle, Jane, w. of Wm., d. 6/6/1814, ae. 21 yr. 3 mo.  
 10, Coburne, Martha, w. of Wm. d. 2/10/1816, ae. 45 yr.  
 110, Comstock, John B., b. 2/26/1811, d. 11/20/1858  
 36, Conkling, Abiar, w. of Thomas, d. 14/10/1779, ae. 83 yr.  
 37, " Thomas, d. 10/15/1793, ae. 93 yr.  
 65, " Mary, w. of above, d. 1/29/1729/30, ae. 24 yr.  
 87, # Elizabeth, w. of Stephen, d. 4/12/1760, ae. 23 yr.  
 buried with two children.  
 161, " Mary, w. of Elkanah, d. 11/28/1834, ae. 88 yr.  
 ---- Crawson, Edgar, d. 7/28/1873, ae. 33-5-12  
 92, Driggs, Amelia, w. of Roswell, d. 4/10/1836, ae. 40-5-2  
 99, " Driggs, d. 9/17/1848, ae. 59-9-2  
 162, Fitch, Amelia, d. 2/4/1833, ae. 63 yr.  
 15, Gould, John W., s. of Thomas & Abigail, d. 3/6/1815, ae. 10 mo.  
 16, " Thomas, d. 3/26/1823, ae. 52 yr.  
 18, " Susan E. dau. Thomas & Abigail, d. 5/3/1837, ae. 26-7-18  
 38, " Ebenezer, d. 11/29/1804, ae. 81 yr.  
 39, " Rebecca (Conklin), d. 4/19/1825, ae. 90 yr. } LIVED IN WEST-NECA.  
 40, " Egbert, s. Ebenezer & Levina, d. 9/19/1813, ae. 12/4/6  
 41, " Jenett, dau. of above, d. 6/7/1815, ae. 18 yr. 10 mo.  
 42, " James C., d. 10/14/1820, ae. 22-4-13  
 43, " Levina, dau. Ebenezer & Levina, d. 7/10/1825, ae. 18 yr. 6 mo.  
 44, " Ebenezer, d. 7/17/1844, ae. 78 yr.  
 45, " Levina, w. of Ebenezer, d. 2/13/1850, ae. 84 yr.  
 29, Gaines, ----, Mary, w. of Dr. Samuel, dau. Thomas & Anstreas Woodward,  
 d. 2/26/1861, ae. 73 yr.  
 129, Gardiner, Mary L. dau. Mathew & Martha, d. 12/22/1826, ae. 10 mo.  
 53, Gladson, Wm. b. Eng., d. 2/18/1848 ae. 63 yr.  
 54, " Phebe, w. of above, d. 5/13/1866, ae. 81-2-22



- 164, Halsey, Adeline E., b. 11/7/1810, d. 7/23/1811, ae. 8 mo. 15 da.  
 68, Ireland, Tabitha, w. of DANIEL, d. 7/23/1833, ae. 80 yr. (Daniel was rev. soldier)  
 119, Jones, Rev. Eliphelet, Minister here, 1676 to 1723,  
 b. Concord Mass., d. 6/5/1731, ae. 91 yr.  
 47, James, Edward, s. of Wm. & Letitia, d. 3/18/1862, at Hampton roads,  
 Civil War, ae. 21 yr.  
 151, Jarvis, Jonathan, d. 7/25/1795, ae. 77 yr.  
 152, " Augustine d. 8/29/1756,  
 153, " Mehetable, --  
 154, " Wm. Jr., d. 1/16/1749/50 ae. 30 yr.  
 155, " J----- d. 1/18/1754 ae. 4 yr.  
 156, " Charity, w. of Jonathan, d. 3/17/1800, ae. 75 yr.  
 157, " Anna, w. of Wm. d. 1/10/1834, ae. 67 yr.  
 158, " Wm. d. 1/13/1838, ae. 69-6-13  
 174, " Thomas, d. 8/24/1732, ae. 63 yr.  
 175, " Milson, d. 11/29/1732, ae. 60 yr.  
 176, " Jemima, w. of Benijah, d. 10/29/1746, ae. 38 yr.  
 177, " Jemima, foot stone only (dau. of above ?)  
 178, " Anne, w. of Benijah, d. 8/21/1754, ae. 38 yr.  
 179, " David, s. of above two, d. 5/15/1755, ae. 3 yr.  
 180, " Benijah, d. 1/3/1766, ae. 58 yr.  
 181, " 'Aunt' Betsy, dau. Jacob & Nancy, b. 9/22/1807, d. 4/23/1887  
 182, " Nancy, w. of Jacob, b. 11/17/1787, d. 3/2/1868  
 183, " Jacob, d. 4/16/1830, ae. 55-6-29  
 45, Jones, Charlotte, w. of Hallet Jr., d. 4/13/1825 ae. 30 yr.  
 46, " Mary, " " " d. 5/27/1830 ae. 37 yr.  
 47, " Hallet, d. 4/1/1847 ae. 55 yr.  
 47, " Eliza, his w. d. 9/30/1852, ae. 40 yr. ( same grave)  
 84, Ketcham, Hannah, dau. Alexander & Freelope, d. 7/18/1811, ae. 1-4-22  
 85, " Isaac Carll, d. 4/16/1808, ae. 57 yr.  
 86, " Hannah Ette, dau. Isaac & Hannah, d. 10/28/1806, ae. 14 yr.  
 120, Lewis, Hannah, d. 3/23/1859, ae. 71 yr. 4 mo.  
 122, " Henry(Scudder), d. 1/18/1832, ae. 80 yr.  
 121, " Julianna, w. of above, d. 4/21/1839 ae. 77 yr.  
 123, " Richard, d. 5/18/1805, ae. 32 yr.  
 124, " Conklin, d. 10/4/1791, ae. 24 yr.  
 125, Naomi, w. of Joseph, d. 10/1/1776, ae. 36 yr.  
 126, " Joseph, d. 9/24/1781, ae. 43 yr.  
 127, " Joseph, d. 1/7/1797, ae. 31 yr.  
 128, " Mary Almira, dau. Henry S. & Juliana, d. 6/14/1829, ae. 24-10-29  
 130, " Abigail dau of above, d. 12/2/1801, ae. 1-7-27  
 131, " Timothy, s. of above, d. 8/10/1798, ae. 2-11-26  
 132, " Freelope, dau. of above, d. 2/27/1795, ae. 8-10-5  
 133, " Abigail, w. of Joseph Esq. d. 6/2/1787, ae. 74 yr.  
 134, " Joseph Esq. d. 8/8/1765, ae. 56 yr.

- 136, Lewis, Charity, w. of Azas, d. 9/9/1788, ae. 50 yr.  
 138, " Sarah, w. of J. C. d. 12/28/1831, ae. 29 yr.  
 139, " Joseph C. d. 6/19/1848, ae. 51, yr.  
 140, " Mary, w. of J. C. d. 4/8/1847, ae. 38 yr.  
 141, " Mary Almirs, dau of above two, d. 10/8/1836, ae. 1-6-6  
 142, " George, s. of above two, d. 7/15/1841, ae. 1-10-13  
 143, " George W. s. of above two d. 4/20/1849, ae. 2-8-5  
 144, " Mary S. dau of above two d. 5/20/1875, ae. 36/7/8  
 88, Morgan, John, d. 3/13/1730, ae. 48 yr.  
 88, " Titus, s. of above, d. 11/22/1740, ae. 15 yr.  
 48, Rogers, George W., d. 10/31/1853, ae. 34-3-2  
 76, Rolph, Elizabeth, dau. Moses & Deborah, d. 12/1/1825 ae. 5 yr.  
 77, " Deborah, w. of Moses, d. 2/9/1855, ae. 76 yr.  
 78, " MOSES Esq. d. 9/18/1838, ae. 64 yr.  
 79, " Jarvis R., b. 9/4/1813, d. 10/3/1894  
 80, " Mary Elizabeth, dau. of Reuben & Elizabeth, d. 10/6/1840, ae. 9 mo.  
 100, " Elizabeth, dau. of above two, d. 9/23/1853, ae. 84 yr.  
 101, " Mary, w. of Reuben, d. 1-1-1821, ae. 76 yr.  
 102, " Reuben, d. 4/20/1807, ae. 63, yr.  
 103, " Phebe, dau of Moses & Phebe, d. 11/14/1798, ae. 40 yr. 4 mo.  
 105, " Hannah, " " d. 12/8/1763, ae. 15 yr.  
 106, " Phebe, w. of Moses, d. 1/11/1775 ae. 75 yr. 11 mo.  
 107, " Moses, d. 11/20/1791, ae. 73 yr. 7 mo.  
 111, " John, b. 1/9/1791, d. 12/17/1870  
 113, " Experience, b. 11/30/1793, d. 1/30/1850  
 114, " Harvey, b. 2/2/1789, d. 9/21/1841  
 116, " Platt, d. 6/22/1822, ae. 38-5-9  
 117, " Mary, w. of David, d. 1/26/1829, ae. 73-10-10  
 118, " David, d. 12/10/1837, ae. 76-8-3  
 159, Rogers, Capt. Eliphalet, d. 12/14/1862, ae. 66 yr. 24 da.  
 160, " Sarah, w. of above, d. 9/10/1873, ae. 72-7-7  
 171, " Ann Elizabeth, w. of Smith, d. 9/19/1862 ae. 39-8-25  
 172, " Amy, w. of Curtis, d. 11/9/1862, ae. 71-6-19  
 173, " Amelia, dau. Curtis & Phebe, d. 7/28/1822, ae. 1 yr. 21 da.  
 ---- Rolph, Harriet W., w. of Jarvis R., dau. Smith Woodhull, b. 10-22-1818  
 d. 7/12/1901  
 50, Satterly, Martha, d. 12/27/1749, ae. ---  
 33, Sammis, Elizabeth, w. of Nathaniel, d. 3/13/1841 ae. 77 yr.  
 34, " Abiah (Conklin), w. of Henry, d. 6/2/1824 ae. 82 yr.  
 35, " Henry, d. 4/8/1809, ae. 71 yr. 5 mo.  
 52, " SILAS, July 1723, ( oldest stone standing in 1896)  
 56, " Stephen, d. 2/8/1763, ae. 28 yr.  
 57, " Philip, d. 5/14/1755 ae. 34 yr.  
 71, " Mary Mehetable, dau. Oliver & Phebe, d. 10/3/1840, ae. 19-6-14  
 72, " Phebe (Corwin), dau. of above two, d. 4/21/1841, ae. 17-7-17  
 73, " Phebe, w. of Oliver, d. 4/30/1859, ae. 63-10-2  
 74, " Herbert (Smith) s. of Smith & Adelia C., d. 9/3/1855, ae. 7 mo. 4 da.  
 80, " Jesse, d. 5/20/1819, ae. 55 yr.  
 91, " Abigail, d. 2/20/1822, ae. 22-8-20  
 95, " John F. s. of Joseph & Rosetta, d. 10/26/1839 ae. 18-5-8  
 89, " Henry R. s. of above two. d. 2/8/1819 ae. 18-1-2  
 96, " Rosetta, w. of Joseph C. d. 1/16/1842, ae. 47-11-1  
 97, " Joseph C., d. 3/24/1850 ae. 54-7-4



- 2, Sammis, Maria Louisa, dau. Wm. & Elizabeth H., ae. 5 mo. 18 da. -----  
 98, Sammis, Cornelia, dau. Joseph C. & Mary, d. 11/23/1845, ae. 8 mo. 19 da.  
 163, Sandford, Edward, s. Dr. James & Elizabeth, d. 4/10/1816, ae. 25 yr.  
 165, " Naomi Adeline, dau of above two, d. 10/30/1794, ae. 5 mo.  
 166, " Dr. James, b. So. Hampton, 4/25/1757, d. 10/20/1795  
 167, " Elizabeth, w. of above, d. 8/6/1825 ae. 64 yr.  
 3, Scudder, Sarah, w. of Jonathan, d. 10/22/1816, ae. 76 yr.  
 75, " Mary, w. of George A., dau. Moses & Deborah Rolph, d. 2/25/1842, ae. 25y  
 2 m  
 55, Shadbolt, Ruth, w. of Abner, d. 4/21/1859 ae. 82 yr.  
 93, Sickels, Sarah, w. of Abraham, d. 5/14/1838 ae. 28-5-10  
 94, " Martha, w. of Henry, b. 12/20/1804, d. 9/7/1839  
 17, Smith, Naomi, w. of Ezra, d. 11/3/1826, ae. 29 yr.  
 66, " David, d. 12/16/1820, ae. 70 yr.  
 67, " Sarah, w. of David, d. 12/8/1824, ae. 74 yr.  
 104, " Martha, ----- illegible--  
 19, Starks, Harriet D. dau. Capt. Jos. & Phebe, d. 2/4/1837 ae. 35 yr.  
 20, " George B., s. of above two, d. 6/9/1830 ae. 30 yr.  
 20, " Phebe, w. of Capt Jos., dau. Thos. Woodward, d. 12/29/1826, ae. 48 yr.  
 20, " Sarah Ann, dau. Geo. B. & Sarah Ann, d. 1/17/1827, ae. 2 yr. 4 mo  
 8, Stockton, Maria, dau. Rev. Philip, (N.J.) d. 6/27/1808, ae. 28 yr.  
 58, Stratton, Jesse U., s. of Ustick & Susan, d. 9/14/1848, ae. 9 yr. 4 mo.  
 59, " Ustick, d. 12/3/1859, ae. 22 yr. 6 mo.  
 112, Swartwout, Sarah, w. Abram, b. 6/1/1797, d. 9/28/1868  
 115, " Thomas A., d. 12/23/1843, ae. 20-7-22  
 11, Scudder, James L. d. 5/5/1881, ae. 45 yr. & 18 da,  
 12, " Lydia E. w. of James L. b. 8/3/1841, d. 8/22/1858  
 12, " Russel C., s. of above two, b. 12/17/1857, d. 7/28/1863  
 3, Smith, Joshua B., d. 1/29/1844, ae. 47 yr.  
 4, " Martha B., w. of above d. 8/3/1840, ae. 42 yr. children  
 5, " Charlotte M. d. 9/17/1826. ae. 2 yr. 1 mo. of  
 5, " Charles H. d. 1/10/1827, ae. 8 mo. 8 da. Joshua B.  
 6, " Martha M. d. 9/15/1835, ae. 3 mo. 5 da. & Martha B.  
 8, " Thomas E, s. of John P. & Anna, b. 1/20/1846, d. 2/4/1846  
 8, " Mary E. dau. above 5/12/1852, d. 6/14/1842  
 8, " Anne P. dau. above, 7/26/1853, d. 8/1/1853  
 29, " Zophar O. s. Henry & Juliet M. d. 8/13/1852, ae. 2 yr. 8 mo.  
 31, " Henry S., d. 5/29/1853, ae. 31 yr.  
 31, " Juliet M. w. of Henry S. dau. Zophar B. & Abigail Oakley, d. 1/12/1854  
 ae. 30 Yr.  
 32, Stuart, Carlos, (no date) (probably d. 1862)  
 ---Symond Mary (Campbell) dau. Carlos & Catherine, b. 4/1/1851 d. 5/6/1932  
 --- Stuart, Catherine (Oakley) -- 1826-1915  
 187, Thompson, Hester Ann, w. Theodore, dau. Eliphelet & Sarah Rogers, d. 2/18/1862  
 60, Tucker, Jarvis, d. 10/2/1810. ae. 19 yr. 6 mo. ae. 21 y  
 184, Turner, Leonard, d. 12/14/1869, ae. 52/5/3/  
 185, " Martha E. d. 2/14/1859, ae. 1 yr. children  
 185, " Ida B., d. 11/8/1856, ae. 3 mo. of  
 186, " Isaac W. d. 9/5/1847, ae. 1 yr 7 mo. Leonard  
 186, " Charles H. d. 10/13/1848, ae. 3 mo. & Sarah  
 109, Tuthill, Mary, d. 6/9/1741 ae. 15 yr.



- 32, Weeks, Ann Eliza, w. of James M. d. 9/23/1852, ae. 27 yr.
- 22, Woodward, Capt. Perez, died at sea, 11/21/ 1818 ae. 45 yr.
- 23, " Lucy, dau. Thomas & Anstreass, d. 6/27/1818 ae. 34 yr
- 24, " Capt. Stephen, d. 8/2/1811, ae. 22 yr.
- 25, " Anstreass, w. of Thomas, d. 12/28/1819, ae. 75 yr.
- 26, " Thomas, d. 1/9/1833 ae. 84. yr.
- 27, " Thomas(of N.Y.C.) d. 7/9/1842, ae. 71 yr.
- 28, " Russell, d. 2/27/1851, ae. 75 yr.
- 61, Wickes, Bathsheba, w. of Capt. John, d. 9/9/1763, ae. 37 yr.

- 62, Wickes, Capt. John, d. 6/5/1801, ae. 79 yr.
- 63, " Elizabeth, w. of above, d. 4/28/1786, ae. 56 yr.
- 145, " Hannah, w. of Eliphelet, d. 5/9/1851, ae. 35 yr.
- 146, " Ezekiel, d. 3/26/1808, ae. 78 yr.
- 148, " Sarah, w. of above, d. 12/7/1808, ae. 72 yr.
- 49, Wileman, Sarah, w. of Richard, d. 12/10/1831, ae. 75 yr.
- 70, Williams, Charlotte, d. 12/23/1838, ae. 67-7-1 (dau. Nathaniel Sr.)

Broken and Unset Stones,  
Sec. 4.

- Platt, Philip, d. 5/12/1748, ae. 43 yr.
- " Jeremiah, d. 10/16/1754, ae. 68 yr. (s. of Epenetus)

Stone dug up when excavation made for  
Memorial Library Bldg.

Conklin, Charity (Rogers), w. of Joseph Conklin d. 2.6.1771

- 24, Carl, Polly B. w. of Elbert, dau. Zophar & Abigail Oakley, d. 2/16/1835  
 21, Dickson, James 2nd., (Middlefield Mass) s. Glaston & Esther, *ae. 16y-9mo.*  
 d. 3/20/1838, ae. 22 yr.  
 7, Downs, Adeliza P., w. Isaac H. dau. Joshua B. & Martha Smith,  
 d. 11/17/1845, ae. 23 yr.  
 48, Haines, Elizabeth Cheney, w. Samuel d. 5/8/1847, ae. 30 yr.  
 11, Ketcham, Chas. Augustus, s. Ezra C. & Jerusha, d. 1/3/1836, ae. 2/3/9  
 13, Kelsey, Hannah, w. of Leander, d. 1/20/1857, ae. 42 yr. 15 da.  
 14, " Leander, d. 2/19/1853, ae. 38 yr. 10 mo.  
 15, " Theodore C. s. Leander & Hannah, d. 4/21/1844, ae. 1 mo. 20 da.  
 35, " Rebecca, w. of John C., d. 8/9/1849, ae. 49-7-27  
 36, " John C., d. 1/12/1865, ae. 71-7-15  
 38, " Eva, dau. John C. & Susan E., d. 2/11/1855, ae. 4 mo. 10 da.  
 39, " Samuel, s. John C. & Rebecca, b. 7/30/1828, d. 11/24/1843  
 40, " Platt, d. 6/12/1816, ae. 60 yr.  
 41, " Sarah, w. of John C., d. 2/25/1818, ae. 19 yr.  
 42, " Amelia, dau. Platt & Mary, d. 5/24/1817, ae. 18.  
 44, Mary E. dau. Jesse & Phebe, d. 11/12/1857, ae. 32 yr. 3 mo.  
 18, McDUGAL, Rev. James, Pastor Ist. Church 1836-1855, d. 3/24/1888, ae. 83 yr.  
 19, " Julia, w. of above, d. 3/24/1870, ae. 66 yr.  
 20, " Charles, s. of above two, d. 10/1/1841, ae. 9 mo. 1 da.  
 22, Oakley, Charlotte B. w. of Zophar B., d. 4/17/1887, ae. 87 yr.  
 23, " Mary, dau. above two, d. 12/23/1854, ae. 17 yr.  
 25, " Margaret, dau. Zophar & Abigail, d. 7/13/1823, ae. 2 yr. 3 mo.  
 26, " Ianpha, " " " d. 8/11/1833, ae. 4 mo.  
 27, " Abigail, w. of Zophar B., d. 3/29/1835, ae. 37 yr.  
 28, " Zophar B. d. 2/25/1858, ae. 64 yr.  
 49, Pooley, Addie, dau. John & Charlotte b. 10/15/1866, d. 11/1/1866  
 43, Walters, Mary Elizabeth, dau. Peter & Elizabeth, d. 9/25/1821, ae. 37 yr.  
 1, Wemyss, Lt. Col. James, b. Scotland, d. 12/16/1833, ae. 85 yr.  
 9, Wood, Jennett, w. of Wm. J., Dau. Abel Conklin, d. 1/23/1838, ae. 26 yr.  
 10, " Oscar, s. of Wm. J., & Jannett, d. 8/2/1837, ae. 77 yr.  
 34, " John, d. 9/24/1751, ae. 77 yr.

Broken & Unset,

--- Jarvis, Alexander, s. of Eliphelet & Ruth, d. 7/29/1763, ae. 6 mo.

The fence surrounding the cemetery was given by the D. A. R. 1925

The Liberty Pole, by the S. A. R., 1953.