

Section Map No 1 Plot A Lot 1  
 James Commons

1

Date	Names	Residence	Age
Sept 7 '62	Caroline - wife J. H. Oration	dent. P. J.	29-0-0
July 3 '78	Miss Commons	"	49-11-23
Dec 30 '91	Caroline Commons	mid.	85-11-21
May 13/1914	John Hammond Oration	"	87-5-10
June 9/36	John Ellis Oration	P. J.	80-3-27
Nov 11/33	Florence S. Oration	P. J.	74

Section Map No 1. Plot D, Lot 36  
 Ralph B. Dayton

Nov: 1946 Endowed for \$400.

June 5/1946 Ralph B Dayton P. J.  
 Dec 27/1945 Bertha Craven Dayton P. J.

Section Map No. 1, Plot B, Lot 12

Date	Names	Residence	Age
Apr 29 '51	Lewis J. Randall son	Randall	22.14
Dec 3 '56	Catherine " wife	"	26.9.19
May 3 '61	Edgar B " son	"	0.0.44
Apr 9 '82	Catherine St. Raymond's	St. Raymond's	26.6.28
Sept 8 '82	" " "	St. Raymond's	0.5.0
Oct 23 '83	Josiah B. Randall	"	64.11.10
May 1 '95	Mary E. Randall	"	75.9.26
" 10 '95	Harry D. Randall	"	56.
Feb 25 '29	Alga Woodhouse Randall	Branford Conn.	92.11.6
Jan 14 '32	Charles P. Randall P. (L.P. Address C.B.D. Inc)	"	83

Referred to New Book 116

Section Map No. 1, Plot B, Lot 21-22  
Benjamin T. West

Jan 24 1942	Samuel Thigden West		57-7-25
Jan 8 1965	Benny T West		75

See Map of Plot 15 Lot 77

Roll Naid W. C. Allen (C.B.D. Inc)

Feb 13/29 Roll N. N. South Stamps 36

this body disinterred and removed to Sayville New York by Raymond's Funeral Service Oct 24-1944 =

Also No 2. in Quinn's Book 2 page 161

This lot bought back by C.H.C. Ass'n Dec 9-1944 for \$125.

SOLD TO JOHN MURPHY

# Section Map No 1 Plot A Lot 15<sup>3</sup>

Date.	Names	Residence	Age.	
Aug 19/48	Emily L. Griffin	Post Jefferson	1.	
Oct 21/57	George E. Griffin		do	2.
Nov 11/55	Mary E. Griffin		do	10.
Nov 1/61	Addie Eliza Griffin	do	44-10 m	
July 3/68	Margaret C. Griffin	Post Jefferson	13.	
Dec 17.88	Mary A. "wife" byrus-	"	leg.	
" 9 96	Iva E Hawkins dnt Isaac	Norwood	16.00	
" 12 "	Annie S "	"	0.13.	
" 10 "	Ethel T "	"	0.00	
Aug 13 80	Willard K "	Removed from Sub. G lot 10 " " page 23	1.8.9	
Aug 25 1906	Byrus E. Griffing	Sayville	88	
Jan 25-1924	James E. Krawley	undertaker James T. Pratt Co, West Hartford	41-10-25	
Burial #	536 Isaac H Hawkins	at 13 Davis local		
"	# 518 Fannie E Hawkins			
"	# 2001 Frank Sallmann	age 79 died May 18 1970		
"	1982 Myra Sallmann	age 72 May 15 1968		

The above lot deeded to Fanny Hawkins  
June 1 1894

Section Maple Street Plot B Lot 17<sup>16</sup> 1818

Date	Names	Residence	Age
Aug 23 '70	Elizabeth Wilson	deat. Schutt Brooklyn	0. 2. 3
Sept 13 '73	George H. "	son Fred W. P.O.	0. 2. 0
Nov 30 '75	Alfred D. "	son Reab H. "	34. 4. 29
Nov 10 '76	Reuben H. "	"	66. 7. 26
June 1. '80	Alfred D. "	son Fred W. "	0. 10. 0
Aug 17 '80	Jane H. "	wife R. H. "	67. 6. 6
Dec 15 '80	Reuben H. " Jr.	son " "	35. 1. 20
Mch 20 '82	Maria L. H. "	wife Fred W. "	41. 4. 5
Apr 20 '92	Frederica E.	deat. " "	14. 6. 4
Aug 16 '93	Eliza A. Wilson	"	76
July 13 1904	Frededene M. Wilson	"	60 yrs
Dec 28 1905	Erna Hart Wilson	sd of Gilbert Brooklyn	47 yrs
May 23 1907	Caroline Hart Wilson	wife of Gilbert H. Wilson	74. 6. 25
May 13 1911	A Still Born	from Singapore	
Dec 30 1911	Gilbert H. Wilson	amator Brooklyn	
Mar 29 1922	Mattie L. Wilson	wife of Rob (1833) Port Jefferson	50
Dec 19 1928	Harriet A. Tolson	Brooklyn	80
Dec 13 1928	Effingham Wilson	Brooklyn	66
Mar 1 1929	Joseph Sargent Tolson	Jacksonville Fla.	68
Burial # 322	Issac Douglas		
" # 31	Jane Douglas		

Section Map Plot B. Lot 2. <sup>5</sup>

Deed must be returned  
paid Jan 27, 1925  
\$ 500.

Date	Names	Residence	Age
Sept 5 1904	Phebe L. Hulse deat.	E. Settle	0-2-26
July 7 1949	Ida A. West wife of H	"	37-8-6
April 9 1907	Mary J. Hulse " Sylvester	"	74-11-27
Dec 18 1921	Henry S. Hulse son Sylvester	" (G.B.S.)	66-0-0
Mar 17 1926	Sylvester Hulse	E. Settle	95-0-0
Dec. 12 1956	Henry Sylvester Hulse		76

Section Map No 5 Plot 2 Lot 85

Phebe E. Beale

Georgetown - care

May 1 - 1921	William C. Beale	P. J. (G.B.S.)	70-0-0
--------------	------------------	----------------	--------

# Section Map Plot B Lot 1

Date	Names	Residence	Age
July 29/60	Frank E. Heule	Port Jefferson	39.0.4
April 79	Mary	"	39.1.23
Dec 12. 81	Jas. Ellsworth	"	20.0.28
Nov 28. 96	Percy A	"	21
Aug 4, 1903	David Bourlier removed	Sec 3 Port Jefferson	
Feb 28, 04	Daniel Heule	Port Jefferson	87.3.21

Sec Map 2 Plot 3 Lot 5

Leon G. Bourlier

Aug 4 1903	David Bourlier	Phil. Pa	49
Dec 16 1924	Elise Bourlier	Undertaker P.B. Davis Yaphank	71-0-0
Burial # 28	Henry W. Brown		
" # 323	Isadore Brown		
" # 1441	Margaret E. Johnston		
" # 1569	Harry Kellers		

Section Map No. 1. Plat D. Lot 1. Jeremiah Darling

Date	Names	Residence	Age
July 30/44	Mary E. Darling <small>daughter</small>	Port Jefferson	1 Yr. 9.
Dec 6/62	Wm. W. Darling <small>son</small>		18. 57
June 58	Mary A. " <small>daughter</small>	"	5. 5. 11
Feb 22 72	Edwin J. " <small>son</small>	"	24. 9. 22
June 6. 66.	Mary E. " <small>Wife Eibert F.</small>	"	24. 1. 29
Apr 19 88	Mary J. " <small>Wife Jeremiah</small>	Stony Brook	47. 2. 13
Jan 18 94	Jeremiah Darling	"	78. 5. 16
Dec 6 07	Bryant J. Darling	Brooklyn	44. 5. 22
April 8-1925	Charles J. Darling <small>undertaken @ 13 Davis</small>	Huntington	67-8-16
Oct 16 1963	Harriet Darling <small>(ashes)</small>		

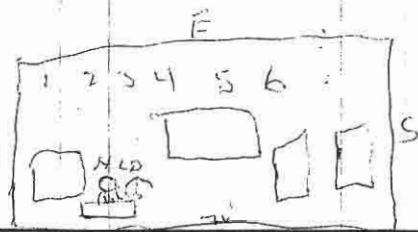

Section Map 6 Plat J Lot 6  
A. J. D. Kuehn

Feb 7 1913	Sarah V. Kuehn	Harlem Hospital	50 years
Sept 19	Alexander J. W. Kuehn	N.Y. City	77 years
	Burial # 91 Walter Kuehn		
	" # 269 Walter Kuehn Sr.		
	Burial # 2018 Etta Kuehn	Died Dec 25 1968	

Section Map No. 4 Plot No. 19. Lot 19.  
Lewis F. Tooker

Date	Names	Residence	Age
Mar 7 54	Thos. L. Tooker son.	Remond P.J.	0.8.7
Apr 30 58	Albertus "	" "	0.6.20
Oct 31 61	R. Alice "	" "	2.6.22
July 11 83	Lewis H. "	" "	55.7.29
Oct 28 1916	Lewis H. " son	L. Trunk Philadelphia	32
Jan. 28, 1920	Mary Jane Tooker	Port Jefferson.	89 yrs
Aug. 5. 1926	Willard F. Tooker	Port Chester, N.Y.	63 yrs
Above Plot to be known as Willard F. Tooker plot 4/27/34.			
Oct 30-1941- The above plot transferred by Deed Claim deed to Harold F. Tooker Passing No. 71-0-0			
Nov. 8 1939	Harold Walter Tooker	Passing No. slip	72-6-161
Oct 11 1944	Katherine H. Tooker	slip	84-0-0
Dec 30 1948	Ernie Tooker	John Worth Fla	

Section Map No. 4 Plot No. Lot 111.

Francis Hutchinson.

Oct. 11-1917.	Francis Hutchinson.	Port Jefferson.	72-7-27
MARCH 28 1930	ELIZA, WILKES, HUTCHINSON.	" " O B DAVIS	80
Burial # 1147	George Hutchinson	WINDY TAKET R. Allen	
" # 1557	Lenore Hutchinson		



Section 2 ~~Map~~ Plot D. Lot 2<sup>d</sup>

Date	Names	Residence	Age
Sept 2/53	Charles E. Tooker	Port Jefferson	9 mo
July 18/53	Julia E. Tooker		7
Dec 24-86	Katherine Tooker wife	Brooklyn	61
Dec 2 93	Alfred Tooker	"	74.6.13
Mar 23/33	Mary Augusta Tooker	Stony Brook N.Y. (O.R. Davis Inc.)	85
May 31 936	Francis E. Pond	Stony Brook	
May 31 1942	Walter H. Nevins	Stony Brook	
May 10 1944	Mary W. Woodruff	Brooklyn	
Oct 4 1964	Bertha E. Nevins	Vault Buried #1798	

Section 2 Plot F. Lot. 42.  
Fred A. Hall.

Jan 21	Louis H. Dickerson	Port Jefferson	90. - -
Nov 26/47	Lilla Ritter	J.R. Essie (O.R.O. Inc)	51 - -
May 31 1932	Emily Jane Hall	East Patchogue L.I.	84
June 1 1934	Frederick A. Hall		76-5-19
Dec 28 1934	Milton Hall	Yaphank	78-10-16

Section Map No. 17 Lot 17

Date	Names	Residence	Age
July 4 84	Infant Miss H Aldrich	J	still burk
Jan 7 93	William B. Aldrich	"	65.1.29
Feb 11 1901	Mary C. Aldrich	"	69.3.21
July 15 1913	William H Aldrich	"	63-
Aug 24 1917	Stephen A. Titus	home for incurable N.Y.C.	61-6
Sept 18 1920	Cornelia R. Aldrich	Estter N.H.	71-11-23
Sept 23 1931	Wm. A. Titus (Titus Vault)	La Grange, Ill. (Ballouwell & James, La Grange)	51.6-16
June 23 1933	Mary E. Titus	Pat. Jefferson, N.Y.	74-8-29
June 30 1952	Edna S Titus	mt. Sinai (O.B. Kauer Inc)	

Section Map No. 5 Plot J. Lot 92  
 Conklin M. Hulse & Jerome Hart

Aug 3/22 Mary E. Hart <sup>undertaken</sup> O.B. Davis Terryville N.Y. 22-  
 Nov 24-1939- Caroline L. Hulse transferred here from  
 - Lot 114 - S M 5 Plot  
 Burial # 626 Conklin Miles Hulse

Section Map No. 1 Plot D Lot 4. 11

Names	Residence	Age
Sam'l Gates	Remov'd from Story Brook	85 1/2
Zibier "	wife Sam'l	86.3.0
Wm N. Bayles	Removal. <i>of</i>	23 10.21
Caroline "	wife Alfred "	61.2.9
Chas L "	son Elisha Removal,	1.5.5
Alfred Bayles	<i>of</i>	87.5.29
Ruth A. Bayles	P. Jefferson, L.D. (O.B.S.) (J.R. Addie)	86
Herman Aldrick		
Martha Aldrick		

W 112  
97  
*done*

Section Map No. 5 Plot J Lot 94

August Scheffler		
Anna Scheffler	Undertaker O.B. Davis	East Setauket 39-0-0
August "	O.B. Davis	
# 469 Robert B. Ford		
# 1768 August H. Scheffler		91 yrs. Mar 15 1904
E 1/2 Transferee to daughter Anna a. Runyon Black Cat Brook 72		

Section Map No 5 Plot D Lot 26

Date	Names	Residence	Age
------	-------	-----------	-----

	Benjamin Hall	of	
	"	Chil Burg	
Aug 17 75	Sam B. Clark	deat Stephen	0.5.17
July 30/12	William N. Synn	"	29-10-5
July 5/21	Mary L. Clark	"	74-0-0
March 25-1944	this lot transferred to Grace L. Latham		
July 19 1952	Grace L. Latham	"	
Aug 11 1943	Stephen H. Clark	"	
Jan 28 1947	Howard Ruff	Islip	
Dec 23 1952	Charles Latham	P. G.	

JAMES EBANES # 5+16

March 25 1845

Section Map No 5 Plot D Lot 7897

Adolph Johnson

Jan 11/23	Grace Johnson	wife <sup>undisturbed</sup> G. H. Barnes Chas. J. Toker	New York	29-0-0
Aug 18/26	Harry B. Sator	Oscar Johnson	Brooklyn N.Y.	45-0-0

Burial # 1136 Josephine Johnson

- 11 # 975 Geo. E. Hulse
- 11 # 819 Anna M. Johnson
- 11 # 705 Emma C. Johnson
- 11 # 308 Hulda Hulse
- 11 # 278 Willy Johnson

correct  
 98' approx  
 95' approx  
 4' approx  
 1-10-1925

Class To Johnson  
 409 Marcellus Rd  
 zip 4501  
 Check the books for 1968  
 inquiry about space.

Section Map No. 5 Plot D Lot 58/16

Date	Names	Residence	Age
	James Madison Bayles died Nov 9 1849 age 69		69
Nov 18 71	Charlotte S. Bushell	P.J.	71.3.8
July 24 78	Julia A. Bayles wife of Frank	"	29.9.11
Jan 24 80	Hester A. "	" Jas W	61.1.18
Aug 23 82	James R. "	" Jas E.	39.0.10
March 14 89	James M. "	"	74.2.18
May 30 1897	Samuel A. Bayles (Cub Saloon Long Harbor)	"	63-0-0
Feb 16 1909	Minnie Bayles Mack died Sunshine Sanatorium Bismarck Hospital	"	42--
Oct 9 1914	Laura C. Bayles 2nd wife of Frank	"	66-5-15
Aug 27 1918	George F. Bayles son of	" P. J.	35--
Jan 1 1919	Annie Shepard Olmsted	Port Jefferson	69 yrs
Jan 18 1919	Stephen Labor Bayles	Port Jefferson	64 yrs
Apr 1 1919	Albert C. Olmsted	Home for Incurables, New York	71 yrs
Mar 22 1920	George Frank Bayles	Port Jefferson	74 yrs
Sept 27 1922	Hamilton T. Bayles	(undertaker) S. R. Fisher buried at West Pond	69 "
Aug 26 1927	Harvna B. Bayles	3 brought to P.J.	70--
Jan 27 1929	Elvina Bayles	Brooklyn	82--
Dec 10 31	Rosalie Josephine Bayles	Belle Terre, Tenn. (C. B. D. Inc.) (undertaker) (S. R. Fisher)	73
	Wife of Hamilton T. Bayles	(C. B. D. Inc.)	
Buried #119 8 1/2	Other Bayles died		
Mar 23 1909	James E. Bayles name should be here		
Buried #31	Erna A. Bayles 1906		
Apr 3 1932	Lynna Loran Bayles P.J. (S. R. Fisher) (C. B. D. Inc.)		83

Section Map No. 5 Plot J Lot 93

	Martha Ritch		
April 3/23	Wilson Ritch	(undertaker) S. R. Fisher Port Jefferson	72-0-0
May 8/27	Martha A. Ritch	Palmer N.Y.	65-8-

James M Bayles, Plot 10 S-F 5# 16

13A

<sup>sect. 1</sup>  
Burial # 5 H3 Wilhelm Mack

" # 665 Elbert C. Bayles

Section Map ~~Plot~~ Plot D. Lot 15  
James L. Looker

Date	Names	Residence	Age.
Feb. 21 83	Errett Hamilton Looker	son J. L. Jr. N.J.	0. 2. 23
Dec 18, 1901	James L. Looker	Perth Amboy	68. 10
April 27 1908	William H. Looker	Leicester N.J.	46
March 24/14	Letty L. Looker	Perth Amboy N.J.	85-3-0

Section Map No 5, Plot J, Lot 90 } ~~East half of this~~ NORTH  
 } ~~lot sold to~~ Eloy Robinson }  
 } August 1926 } J.S.

George F. Richards

June 26-1923	Mary M. Richards	Undertaker O. B. Davis	Port JEFF Station	77-0-0
Burial # 290	Ethel Rogers			
" # 1669	George Richards			
" # 1799	Rose Richards			

Eloy Robinson

~~East half of~~ Lot 90 Plot J Sec Map 5  
 NORTH HALF " " " " " "

Burial # 1156	Eloy Robinson
" # 1614	March Robinson
" # 320	Phoebe Altin

Section Map Plot No. 9 Lot 6<sup>15</sup>  
 Hamilton Lookin

Date	Names	Residence	Age
Apr 26 1859	3 boys W. Hooker	Setauket	44 <sup>m</sup>
Feb 46 49	Charles W. Hooker		do
July 12 63	Thobest "	P.J.	19.0.0
July 22 73	Eduard Post "	"	34.11.-
July 21 76	Hamilton "	"	71.2.5
Mar 75 '86	Maria Tooker	Wife of Hamilton	79 4.12
Aug 16 74	Margaret Elizabeth Tooker	undertaker G. B. Davis	83, .
June 18 25	Inez Powell (colored)	"	70.-

Section Map No. 7, Plot F. Lot 72  
 William Baldwin

June 9-1923	Stillborn of Harold	undertaker G. B. Davis	P. J.
Jan 29 1955	John L Baldwin		Serial # 1299
Oct 31 1956	Luce A Baldwin		" # 1387
	Sarah Baldwin,		
	William Baldwin,		
	Elizabeth Baldwin		" # 1313
April 14 1955	Caroline Baldwin		



## Section Map No. 14 P.D. Lot 14

Date	Names	Residence	Age
July 31 '74	Sylvester S. Wines	P.J.	45.5.0
Feb 26 '75	Frederick S. Saxton	son of Mrs. Wallace	1.4.26
Feb 7 1917	Richard A. Bayles	son of James T. Bayles	13
Jan 14, 1920	David H. Bayles	Asbury Park	8 days

## Section Map 7. Plot K. Lot 28

Mary Goebel

Burial # 1120 Mary Rhoda Goebel  
 " # 2010 Chest Mills

## Section Map 7. Plot K. Lot 13

Henry Miller

Aug 11, 1923 Mamie A. Miller Undertaker  
 G. A. Davis Rocky Point 0-5-0

Burial # 285 Florence Miller  
 " # 773 Henry Miller Jr.  
 " # 1053 Charles Bentilan (Scanlan)

Section Map ~~Map~~ ~~Plot~~ ~~Lot~~ 7

Date	Names	Residence	Age.
Mar 22 61.	Wallace J. Hallocks Child of do.		29.1.1
Apr 29 73	Walter E. Leek son Wellington P. Leek	P.J.	01.9
June 19 80	J. Rockwell Cooks.	Greenpoint	27.6.0
Aug 27 82	J. Rockwell Cooks Jr	P.J.	2.0.0
Jan 17. 87	Ida M. Leek and J. Rockwell	"	31.9.0
July 3, 1901	Walter Leek	"	72.9.0
Sept. 29-1917.	Dorothy A. Leek.	Port Jefferson	87. —
Jan 20/25	Wellington P. Leek	"	73. —
Mar 21/30	Annie P. Leek	OR. address B'KLYN. N.Y. O B DAY IS LNE	80. —

~~Section Map 7. Plot K. Lot 29.~~  
~~John Appleby.~~

Section Map 7. Plot K. Lot #12  
Mrs May Kroeger

July 21-1923 Mary Kroeger Undertaker  
E. B. Davis Gaphank 63

Section Map 7, Plot D Lot 31.

Date	Names	Residence	Age
Nov 7, 1901	William J. Hulse	Port Jefferson	66.5.10
Aug. 21. 1917.	Louisa B. Hulse wife W.J.	Hartford, Conn.	78-11-18

Section Map 7 - Plot X - Lot 27

Jennie Borthwick

Feb 4, 1919	Chas. Atkinson Borthwick Removed from the Map 2 Plot 7, 1868.		
	Burial # 727 Grant Borthwick		
	" # 912 Jennie Borthwick		

Section Map 7, Plot K, Lot # 26

Henrietta L. Wells

May 24/23	Ernie Baum	Undertaker O. B. Davis	Jersey City	38
Aug 30/1958	Jovanana "	1955	1055	9341

Section Map #1 Paper Lot 24.

Date	Names	Residence	Age.
May 1887	Mary B. Heule	Port Jefferson	19 <sup>3</sup> / <sub>4</sub>
Sept 64	Charles L. Hales	do.	24. 2. 24
Oct 12 1886	Charles Brown Woodhull	Bridgport	3 weeks
May 11 98	Esther T. Edwards	do.	85 3. 11
Nov 17 99	Charlotte A. Hales	East Petankat.	72 yrs.

Section Map #7, Plot K, Lot #14

Elin D. Goomeer

Aug 29, 1923	Gustaf E. Goomeer	Undertaker C. P. Davis, Terryville	72-0-0
	Burial # 148 E. Goomeer	do	
	" #1124 Elin E. Goomeer	do	

Section Map #7, Plot K, Lot #15

Esther L. Gould.

Nov 5/23	William B. Gould	Undertaker C. P. Davis Port Jefferson Station	83.0.0
----------	------------------	--	--------

Section Map No. 1, Plot D, Lot 30.

Date	Names	Residence	Age
Transferred to Charles S Brewster Jan 10, 1903			
	Infant Chas S Brewster		Still born
Dec 26, 1902	Mary S. Brewster	Port Jefferson	76
Aug 20, 1905	George F Brewster	"	26
Jan 17, 1924	Charles S. Brewster	undertaker C.B. Davis	71
FEB. 1 1930	NANCY I BREWSTER WIFE C S BREWSTER	"	75
Dec 24, 1962	Hattie T Brewster	"	"
Feb 3, 1946	Charles Murry Brewster	Buried #1921	83 yr.

Section Map #1, Plot D, Lot #39-38  
W M. Wadsworth

Note The above (2) Lots were transferred to  
Mr and Mrs Frank S Childs of Port Jefferson  
on November 21st 1931 David A Baldwin Secretary

July 18-1947- These Lots Enclosed for \$600. =  
Mar 25 1959 Mr. Frank S. Child

19.  
20.

24  
3

Section Map No 5, Plot A, Lot 25

Date	Names	Residence	Age
1859 <sup>7/10</sup>	Lewis Hulbe	Port Jefferson	57
" 1861 <sup>10/21</sup>	Martina S. Hulbe	do	21
" 1868 <sup>11/28</sup>	Martina S. Hulbe	do	7
May 27/69	Thomas Bell	do	65
Jan 13/72	Martina Bell	do	71
Dec 22/73	Julius G. Bell	do	44
Jan 17/75	Wm W Bell	do	44
May 28/76	Caroline Bell	do	4
Aug 2/76	Wm Bell	do	19
May 19/77	Joseph Garand	Removal	16.0.0
Aug 6/79	Agnes Gerard, son age		0.8.20
June 21/73	David C Hulbe	P. J.	28.1.10
Nov 18/78	Eliza A Hulbe	P. J.	76.7.4
Mar 5/95	Angelina M Hulbe	"	61.7.19
Sep 15/96	Sarah A A Milne	"	55.11-

Wm W Bell  
Removal to  
Candy

Section Map No 5, Plot J, Lot No 99  
John W. Stout

Masterly Real Estate  
this plot under  
sold by suit claim  
Died test

Sept 29/23	Louise M. Stout	undertaker O B Davis	Carl Edward Nielson
Jan 5/27	Theodore T. Stout	Miller Place	9/3/32
Jan 28 1930	THEODORE STOUT	SON OF ABOVE MILLERS PLACE O B DAVIS UNDERTAKER	47
MAY 23 1930	JOHN M STOUT	do CHICAGO ILL UNDERTAKER E G SHUTE W O B DAVIS INC	58
June 5/32	Wilhelmina A. Nielson	Py. (J. R. addis. O. B. D. Inc)	70

Burial # 790 Carl Edward Nielson

Section Map No. 3, W. C. Lot 32  
George S. Saxton

Date	Names		Residence	Age
Aug 11 59	Harry S. Saxton	wife Geo.	P. J.	25
Sept 26 68	Franklin	son	"	1 1/2
Apr 5 84	Effie Giles	deat Geo	"	1.30
Sept 30 118	Cornelia C	wife Geo	"	69-10-
Nov 12/15	George D	"	"	79-3 1/3

Section Map 7 Plot K Lot 5  
Charles D. Kinner  
E. M. Lewis  
Connell

Sept 6 1918 Viola Virginia Kinner last child of Kinners  
 Body removed from this lot Sept 21<sup>st</sup> 1934 and  
 interred on lot 75 - Map 2 - Plot E (Kinners &  
 Henderson lot)  
 Deed for above plot returned to cemetery comm. 9/30/34  
 lot bought back by Association for \$100  
 and sold to Mrs Lewis Conley for same 4/8/35  
 Burial # 224 Hannah J. Nelson  
 # 115 Nelson Nelson  
 see Nelson Nelson card

Section Map No 3 Cape Plot 6 Lot 10.  
 Charles Hawkins

Date	Names	Residence	Age
Nov 29/77	Justin Woytkin wife Henry	Setauket	74 yrs
Dec 1/78	Henry Hawkins	Setauket	76 "
Sept 29/85	<del>Justin</del> Woytkin's dau Henry	} Removes from Setauket }	10 "
May 19/88	Corneilia A Hawkins		1 "
Aug 13/80	Willard H " son Isaac	Removes to page 3	18-9
Jan 26/97	Charles Hawkins	Norwood	44.1.26
Dec 21 1910	Fannie A Hawkins wife of	Lebas	844-17

Section Map 7 Plot K Lot 6  
 Annie Petersen.

Nov 14 1918	Harold A Petersen	Port Jefferson	32 yrs.
-------------	-------------------	----------------	---------



Section Map No. 1 Plot A. Lot 14.  
George W. Hastings

Date	Names	Residence	Age
Feb 6 66	Jerusha Hastings wife	G.J.	42.10.26
Oct 2 69	Charles W Hastings son	"	0.1.1
Mar 4 74	Wm. V. Hastings son	"	1.1.1
June 22 '77	George W Hastings	G.J.	66.10.23
	Burial # 152 Simeon W Hastings		
	" # 213 Alice Hastings		
	" # 747 Anna Hastings		

Section Map 4, Plot 7, Lot 84  
Joseph Houghton

Oct 10/23	Josephine C. Houghton	Undertaker C.B. Davis Shelanbet	1 Year
-----------	-----------------------	------------------------------------	--------

ib.

na  
rel

Section Map No. 2, Plot D, Lot 23 <sup>25</sup>

Joseph Bayles

Date	Names	Residence	Age
Sep 1919	Mary August <sup>Removal to Lot 159</sup>	Pat Jefferson	2 Mo
Feb 1919	Infant Joseph Bayles	Removal Pat Jefferson	0.1.18
April 24, 04	Joseph Bayles	Total residence 84-4-0	84-4-0
Jan 8 1912	Lucinda A Bayles	Pat Jeff	81-7-6

Section Map No. 2, Plot E, Lot 65 1/2

Robert G. Swenk

Dec 4, 1923	Jacob Warran Swenk <sup>undertaker</sup>	P. J.	4 days
	Robert G. Swenk (father) per Int. Book		
	Burial # 1673 Robert Swenk		

Section Map No. A Plot P Lot 20.  
 Mark Brown

Date	Names	Residence	Age
Deeded to Charles J. Darling Oct 20 1906			
June 24/32	Charles Tooker	} Removed from } Burial } to Cemetery	53
Dec 19/36	Eliza Tooker		7
Mar 15/38	Wanita Tooker		5
Feb 16 57	Ruth H. Bayles	Wife of J. Bayles	Removal 35 u. u.
Apr 25 70	Mary A. Hulse		80.3.21
Mar 16 83	Wm Tooker	in charge	New York 70.1.22
Sept 19 1925	Lucius Frank Tooker		Sound Beach Conn 70-8-30

Above to be known as Willard F. Tooker plot  
 4/27/34

Oct 30-1941- The above plot transferred by  
 quit-claim deed to Harold F. Tooker

Section Map No. 5. Plot J. Lots 66-69  
 Minnie M. Lawrence

May 14-1924	Catherine M. Lawrence	undertaken G.B. Davis	P. J.	10-0-0
July 15, 1927	John Cassidy Lawrence		P. J.	55-0-0
Parent #1006	Edwin A. Lawrence			
" #1093	Clifford Lawrence			
	Henry Barden			
" #1391	Minnie M. Lawrence			
" #1670	Ralph Lawrence			
" #1658	Susie Lawrence			
" #161	William R. Mott Jr.			
" #240	Paul R. Mott			
" #1453	Emie Lawrence			
" #1006	Edwin A. Lawrence			
" #2042	Stanley Lawrence			

May 20 1969 age 67

Section Map No. 5, Plot C, Lot 5. 27  
 Cross N. Satterly

Date	Names	Residence	Age
Oct 18/64	Adalade Satterly	Port Jefferson	98- 21.
Feb. 6 95	King S. DeWick	"	90-3-
July 18, 1901	Charles W Satterly	"	69-
July 7 1907	Sarah Ann Satterly Wife of C.W.S	"	68-7-28
December 31 1916	Jane Elizabeth De Wick	"	98-7-7
Jan 22 1948	Elert De Wick		

Section Map No 5, Plot J, Lot No 98  
 Warren J. Huff

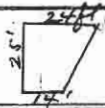

July 5-1924	Catherine H. Huff	Undertaker C. B. Davis Road Brooklyn	73-0-0
Jan 22 1924	Warren Huff	"	77-0-
	Serial # 104 Warren J. Huff		
	# 1292 Fred Huff		

28 Section Map No. 5. Plot J. Lot 22.

Date	Names	Residence	Age
------	-------	-----------	-----

Mar. 5/29	James E. Bayles	Port Jefferson	87-
<i>This is a mistake, should be recorded on page 19</i>			

Section Map No. 5. Plot J. Lot 56. SOUTH HALF OF LOT.

Frank A. Franzen

Oct 23-1924	Emma Franzen	<sup>mistaken</sup> <del>to home</del> <sup>interment</sup>	53-
Burial # 690. Frank A. Franzen			

Section Map No. 5. Plot J. Lot 56. NORTH HALF OF LOT.

Amelia Mohlmann

Burial # 77	Amelia Mohlmann
" # 226	Fred Mohlmann
" # 1980	Arthur Jayne George Loss

Section Map No. 1 Plat. C. Lot 6. 29

Date	Names	Residence	Age
Mar 23/65	Charles M. Brown	Port Jefferson	6.8
Apr 18/65	Sylvester W. Brown	do	17.6
" 7/67	Staney L. "	do	17.6.3
Dec 20/80	Pauline E. "	do	17.0.23
July 30/87	Morris H. Brown	"	69.0.0
Aug 30/914	Mary Brown	"	89.9.20
Burial # 287	Dora Brown		

~~Margaret E Davis's Lot #1 in 7 Plat K~~

~~Public L. Burche~~

Section Map 7 Plat K Lot No 1

~~Eloy at all H. Burche 31 24 1957 interment in k page 11~~  
~~Relph at Burche Mar 6 1957~~  
~~Wesley at Burche Jan 17 1952~~  
~~Edna S. Burche Mar 31 1920~~  
~~John Burche July 31 1921~~

Burial # 397 Margaret J. Gillespie  
 Burial # 844 John C. Gillespie

7541.  
627  
71-yr.

See page 32

Section Map. Plot C. Lot 7

Date	Names	Residence	Age
Apr 20 95	Jesse Aldrich	P. J.	62.1.4
Nov 19 1900	Bernard J. Aldrich wife	Port Jefferson	71
April 26	Jane S. Aldrich Daughter	" "	41-6
May 27-1918	Jane Aldrich wife of <sup>Engels</sup> <del>Engels</del> <sup>Mat. Men. Hooper</sup> <del>Engels</del>	Setauket	50
May 29 32	Clarence Aldrich	East Setauket P. J.	58
May 12 1945	Carrie Ribley Aldrich	Stewart Fla.	

Section Map 5 Plot J. Lot 198.

H. J. McCloy, Chas. G. Atkins, Wm. H. Atkins.

July 10 1919	Willie Elyn McCloy	Port Jefferson	48 yrs.
Nov 29 1921	Evelyn E. Atkins (Daughter of Wm)	" " (C.B.S)	50mo
Nov 17 27	Kenneth S. McCloy	" "	72
Jan 15 1944	Clara Bush Atkins	P. J.	82 yrs. 10-7
Dec 5 1949	Ferry Atkins Carther	P. J.	47mo 19 days
10/10/1959	Dorothy Atkins	Kings Park	39 yrs
Feb. 18 1962	Charles Gardner Atkins	P. J.	72 yrs
10/10 1954			

Section Map No. 1 Plot A Lot 31  
 176 177 178 179 180 181 182 183 184 185 186 187 188 189 190 191 192 193 194 195 196 197 198 199 200 201 202 203 204 205 206 207 208 209 210 211 212 213 214 215 216 217 218 219 220 221 222 223 224 225 226 227 228 229 230 231 232 233 234 235 236 237 238 239 240 241 242 243 244 245 246 247 248 249 250 251 252 253 254 255 256 257 258 259 260 261 262 263 264 265 266 267 268 269 270 271 272 273 274 275 276 277 278 279 280 281 282 283 284 285 286 287 288 289 290 291 292 293 294 295 296 297 298 299 300 301 302 303 304 305 306 307 308 309 310 311 312 313 314 315 316 317 318 319 320 321 322 323 324 325 326 327 328 329 330 331 332 333 334 335 336 337 338 339 340 341 342 343 344 345 346 347 348 349 350 351 352 353 354 355 356 357 358 359 360 361 362 363 364 365 366 367 368 369 370 371 372 373 374 375 376 377 378 379 380 381 382 383 384 385 386 387 388 389 390 391 392 393 394 395 396 397 398 399 400 401 402 403 404 405 406 407 408 409 410 411 412 413 414 415 416 417 418 419 420 421 422 423 424 425 426 427 428 429 430 431 432 433 434 435 436 437 438 439 440 441 442 443 444 445 446 447 448 449 450 451 452 453 454 455 456 457 458 459 460 461 462 463 464 465 466 467 468 469 470 471 472 473 474 475 476 477 478 479 480 481 482 483 484 485 486 487 488 489 490 491 492 493 494 495 496 497 498 499 500 501 502 503 504 505 506 507 508 509 510 511 512 513 514 515 516 517 518 519 520 521 522 523 524 525 526 527 528 529 530 531 532 533 534 535 536 537 538 539 540 541 542 543 544 545 546 547 548 549 550 551 552 553 554 555 556 557 558 559 560 561 562 563 564 565 566 567 568 569 570 571 572 573 574 575 576 577 578 579 580 581 582 583 584 585 586 587 588 589 590 591 592 593 594 595 596 597 598 599 600 601 602 603 604 605 606 607 608 609 610 611 612 613 614 615 616 617 618 619 620 621 622 623 624 625 626 627 628 629 630 631 632 633 634 635 636 637 638 639 640 641 642 643 644 645 646 647 648 649 650 651 652 653 654 655 656 657 658 659 660 661 662 663 664 665 666 667 668 669 670 671 672 673 674 675 676 677 678 679 680 681 682 683 684 685 686 687 688 689 690 691 692 693 694 695 696 697 698 699 700 701 702 703 704 705 706 707 708 709 710 711 712 713 714 715 716 717 718 719 720 721 722 723 724 725 726 727 728 729 730 731 732 733 734 735 736 737 738 739 740 741 742 743 744 745 746 747 748 749 750 751 752 753 754 755 756 757 758 759 760 761 762 763 764 765 766 767 768 769 770 771 772 773 774 775 776 777 778 779 780 781 782 783 784 785 786 787 788 789 790 791 792 793 794 795 796 797 798 799 800 801 802 803 804 805 806 807 808 809 810 811 812 813 814 815 816 817 818 819 820 821 822 823 824 825 826 827 828 829 830 831 832 833 834 835 836 837 838 839 840 841 842 843 844 845 846 847 848 849 850 851 852 853 854 855 856 857 858 859 860 861 862 863 864 865 866 867 868 869 870 871 872 873 874 875 876 877 878 879 880 881 882 883 884 885 886 887 888 889 890 891 892 893 894 895 896 897 898 899 900 901 902 903 904 905 906 907 908 909 910 911 912 913 914 915 916 917 918 919 920 921 922 923 924 925 926 927 928 929 930 931 932 933 934 935 936 937 938 939 940 941 942 943 944 945 946 947 948 949 950 951 952 953 954 955 956 957 958 959 960 961 962 963 964 965 966 967 968 969 970 971 972 973 974 975 976 977 978 979 980 981 982 983 984 985 986 987 988 989 990 991 992 993 994 995 996 997 998 999 1000

Date	Names	Residence	Age
<del>Aug 15/53</del>	<del>Benjamin Brown</del>	<del>Port Jefferson</del>	<del>59 M</del>
<del>Sept 25/47</del>	<del>James W. Brown</del>	<del>"</del>	<del>5</del>
<del>Nov 8/37</del>	<del>Ann Eliza Brown</del>	<del>"</del>	<del>3</del>
<del>Jan 25/34</del>	<del>Sheila Ann Brown</del>	<del>"</del>	<del>1</del>
<del>Apr 15/25</del>	<del>Multon C. Brown</del>	<del>"</del>	<del>1</del>

Removed from  
Port Jefferson

Section Maps A H Plot I Lot 197  
 Louisa J Conk

Feb 1, 21	Charles G. Conk (C.G.C.)	Elsworth Albany N.Y.	2.11.10
Mar 28/27	Edward G. Conk	Port Jefferson	80 -
Jan 18/41	Charles Alfred Conk		78-6-8
Burial # 531	Louisa Conk		
" # 805	Robert C. Conk		



Section Map No 1 Plot A Lot 17

Date	Names	Residence	Age
Aug 26/18	Addie Frank Brown	St Jeffers	51.25
March 1916	B Franklin Brown	" "	78.21
June 1, 1906	Hannah H. Brown wife of B Frank Brown	" "	77-7
Jan 12/09	Joseph J Kirk	Bklyn	54-
Dec 16/28	Henry L Brown	Southern	73-
Dec 19/30	Lannie Brown	Wm. Robert Summit, Pa.	64
May 6 1943	Hattie Brown	Buried 123 age 67	

Section Map 7 Plot X Lot 2, # 23  
 Ursula A. Burke.

Mar 2/20	Anna Francis Burke wife of John	St Jeffers	67 yrs
July 3/21	John Burke	" "	71 years
MARCH 1/24	Ralph E	" "	73 age

Ursula Burke Burial # 1142

Transferred to Ralph Burke  
 By Ursula A. Burke

Aug-17-1946 Lot 18 - Map 7 - PLOK transferred to  
 Margaret Emily Adams South Westly corner  
 Burial # 397 Margaret J. Killispee  
 " # 544 John Killispee  
 " # 1830 Maude E McFarland

Section Map No 3 Plot C Lot 3<sup>33</sup>  
John Fordham

Date	Names	Residence	Age
------	-------	-----------	-----

Apr 67	Johnnie Fordham son Wallace H.	S. J.	08.0
Dec 9 70	John D. Overton	Hempstead S.	1.0.3
Aug 5 63	Hattie A. Davis dau of G. L. Davis	"	02.21
May 5 70	Carnie E	"	02.21
May 1 71	"Baby"	"	01.27
Dec 15 84	Abigail Fordham wife John	"	65.5.17
Aug 8 88	John Fordham	"	74.6.0
Mar 18 92	Maitha F. Davis wife G. L. Mt Sinai		57.10.28
Sept 3 1925	Maria Abigail Overton	Hempstead	75-0-0
1908 Oct. 10.	The north half of this lot was conveyed to Gilbert F. Davis and the south half to Maria Fordham Overton, by T. H. Boston as Executor of the will of John Fordham dec'd.		
Aug 2	Lillian A. Hempstead	dau of Mount Sinai	-1-7
Mar 4 1925	Gilbert F. Davis	Mount Sinai	87. year

Section Map No 6 Plot J Lot 16  
Nancy C. Mott.

Jan. 19 1919	Cornelia J. Mott	Port Jefferson	1 -
Nov 10 1922	Nancy C. Mott	"	73 -
Jan. 14 29	Isabelle Mott	"	39 -
June 8 1948	Ruth Mott burial # 1945	"	"

(This Lot is full)

Section Map No 319 Plat G Hubbard & Gildersleeve Lot 2 1/2

Date	Names	Residence	Age
Apr 2/61	Charles A. Dixon	N. Y. City	4
Mar 14 57	Martin Gildersleeve son	Remond T. J.	0.2.26
May 31 89	Hubbard K. "	Prof	76.7.4
Apr 20 91	Leborah " wife	"	78.
Nov 22 98	Hank B. Gildersleeve son Ed.	"	10.3.-
July 22 1918	Edwin B. "	New Haven Conn.	72.-
June 9 1925	Evelyn B. Gildersleeve	New Haven Conn.	56-9-6
Feb 7 1941	Clarence E. "	"	74-5-26
Burial # 130	J. P. Marren		
" # 581	Ellen "		
" # 1278	Esther Gildersleeve		
" # 1718	Daniel H. Gildersleeve		

Section Map 5 Plat 3 Lot 51  
Eva E. Gildersleeve

Nov 1 1911	Hennieta Gildersleeve wife of Samuel	Port Jefferson	55-7-27
July 1 1865	Conrad E. <del>Wheeler</del> son of Olive	"	37ms.
April 28 1918	Ebenzer Gildersleeve	Port Jefferson	69 - -
Burial # 782	Grace Hove		
Burial # 1252	Chas. Browning		
Burial # 7438	Lester Carnedy		
Burial # 1151	Grace Carnedy		
Burial # 1713	Olin Helleffe		
Burial # 1513	Forster H. Brown		

See New Books  
Page 100

Section Map No. 10 Map C. Lot 11. 35  
 Joseph Brewster & Jacob Willis

27 1/2  
26  
4

Date	Names	Residence	Age
Mar 14 92	Sarah E. Brewster, wife of Jos.	W. J.	74-4-20
Feb 16 94	Jacob Willis	"	80-10-20
" 22 94	H. Augusta Willis	"	72-1-14
" 21 97	Joseph Brewster	"	78-7-25
Jan 2 1913	Henry E. Gray	New York	58 years
July 16 1917	Adelaide W. Wilson	Come for Inmanville	72-6-14

Sect Map 5 Plot 9 Lot #199  
 William H. Kinner

Dec. 10. 1926	Charlotte E. Kinner	Part Jefferson	36-
Burial # 638	William H. Kinner		
Burial # 1002	Emily H. Kinner		
Burial # 1440	Nathaniel Smiley		
Burial # 1503	Waldemar Frey		
Feb 22 1959	Laura Frey		76 yrs.

Section Map Plot A Lot 4  
Daniel H. Skidmore

Date	Names	Residence	Age.
1864			
Nov 24	Mrs. Daniel Skidmore	Setauket	64 2 25
Feb 12 73	Daniel H	"	73 2 7
" 6 67	Rev. Albert F	"	39 4 0
Apr 28 42	Peter	Rumorsal	69 0 4
July 7 53	Hannah H	" (Wife of Peter)	76 11 8
Apr 25 61	Chas A	Son Peter M.	- 0 0 29
Jan 9 91	Ernest H	" " Henry H. E. Setauket	0 1 28
July 3 1902	Peter M. Skidmore	" "	69 8 13
Aug 27	Francis Emily Skidmore	Wife of Peter " "	76 10 1
Jan 21 27	Mary Jennette Skidmore	(O.B. Davis) Bridgeport	84 7 27
May 13 23	Henry W. Skidmore	undertaker C.B. Davis E. Setauket	61
Jan 2 1914	Daniel H. Skidmore	also called on p. 150 Bridgeport	84 4 3

Section Map 4 Plot H Lot 174

Chas E. Hulse

Sept 27 1936

Above lot bought back by Cedar Hill Cemetery & resold to Mrs. Harriet G. Hill - Sept 27 1936 for \$150.00

Section Map No. 1 Plat A. *Eliza Frazer* 37  
Lot 2  
16

Date	Names	Residence	Age
Apr 12/76	Thos E. Terry	Removes from Pt. Jefferson to Ches.	54. 14. 6
	Phil Terry	do	
Mar 7/76	Shadrack Terry	do	82-0-0
Feb 7/76	Method A. Satterly		33-3-2
Aug 13/53	Benj. Brown	Removal	59-9-9
Apr 15/25	Martha E. "	deat Benjamin "	1-0-5
Jan 24/34	Thos. Ann "	" " "	1-3-23
Nov 8/37	Ann Eliza "	" " "	3-1-13
Sept 25/47	James N. "	" " "	5-7-7
June 29/81	Eliza Frazer. widow "	" " "	73-10-11

Llewellyn A. Tripp Certificate # 21, 20<sup>00</sup>  
 Section Map 6 Plat J Lots 33 & 34

Dec 21/1914	Robert E. Tripp	Barjeff Sta	1-0-23
July 8-1917	Clara Helen Tripp	Port Jefferson Station	1.
	<i>12<sup>th</sup> Red + Black Suburban book, Plat below Page 94</i>		
Burial # 22	Arthur Tripp		
" # 757	W. S. Tripp		
" # 538	Llewella Tripp		
" # 925	Mary M. Tripp		

Section Map No. 1 Flat A Lot 3.  
James R. Taylor

Date	Names	Residence	Age.
May 30 '66	James R Taylor	P. J.	40. 0. 0
Aug 7 '56	Maria S do. dent	Remondel	2. 7-7
Feb 15 '75	Edla S do.	P. J.	23. 5-6
Mar 16 '90	Rebecca Taylor		87

1910

Dec 30 The title to this lot has been transferred by Harry Taylor, the widow and Geo. Taylor, a son, to William C. Taylor, a son, by deed dated Dec. 23, 1910. The title is now vested in William C. Taylor.

Sept 9 1913	James R Taylor	Port Jeff	40-6-24
May 16 1915	Harvey C. Taylor	Brooklyn	87-3-18
June 24 1916	William C Taylor	P. J.	66-

June 29-1946 This lot Endowed for \$200.00  
by Edla S. Taylor.

May 22 1941 Henrietta Taylor Stony Brook 89-8-2

Section Map. Daniel Robbins. Plat C. Lot 28. 39

Date	Names	Residence	Age
Aug 23 60	Daniel Robbins	Lock Jefferson	83.7.10
Oct 24 64	<del>Francis</del> Francis Robbins	wife. Married from - do to Country	71.9.7
Jan 26 66	Cherry E	daughter	50.2.28
Nov 11 66	Catharine J	"	63.9.16
Dec 15 78	Irene	"	68.10.23
Nov 25 70	Catharine Darling	wife Leonard	47

Section Map No 5. Plat D. Lot 59  
William Marshall

June 14 1931 Ethel May Marshall (Smithtown Br.)  
 Oct 20 1963 William Marshall # 1747 (w/ J. C. B. Darling) 1/2  
 North half part sold to Lewis Davis  
 Burial # 1499 Lewis O. Davis



Section Map No. 1 Plat C Lot 26  
Chas. J. Robbins

Date	Names	Residence	Age
Jan 26 04	Willie Robbins	son	Removal pg
Jan 26 04	James	daunt	" " " "
Jan 12 71	Fanny	"	8-5-11
Jan 30 71	George L.	son	2-8-20
July 26, 1903	Charles J Robbins	pg	70-10-6
Feb. 7-1918	Mary B. Robbins	wife of Charles J. P. J.	78-

Edward T. Buckingham  
Section Map 5 Plat 9 Lot 33 512

Aug 24 1916 Sarah L. Buckingham Retainer 53.

North half this lot transferred to - see  
Wm. Campbell P. 439  
Interests  
Listed

June 14-1941 - South-west corner of this  
lot transferred to Harold Hawkins - 10 ft. in width  
from north to south - 12 1/2 ft. from east to west



Section Map No 1 Plat C.

41  
Lot 27

Date	Names	Residence	Age
47 40	John C. Robbins	Removes from Pt. Jefferson to Chgo. 11.25.	
Sept 30 63	Isaac	P.J.	58-10-0
244	Died 68	Maria wife Isaac	65-10-18
24	July 16 73	Jane Lawrence	91-05-0
-6	July 13 1942	Maria Robbins	Port Jefferson

Jacob S. Dreyer  
Section Map No 1 Plat D. Lot 35

May 24 1941 Jacob Dreyer Springfield Vt.  
 Nov 28 1953 Virginia 19 Schubert St. Angles Calif  
 May 30 1967 June S. Dreyer Burial # 1941 age 43

Section Map No. 1 Plot C Lot 29  
William T. Robbins

Date	Names	Residence	Age	
Nov 26 45	Catharine Robbins	daut. WTR	Removal	1. 3. 4
Dec 17 48	Martha	"	"	0. 8. 14
May 30 62	William T.	"	"	61. 1. 10.
Nov 1 73	Martha C	wife "	"	67. 2. 0
April 12 80	Emma S	" Isaac	Yaphank.	32. 0. 0
Nov. 7 95	William H. Robbins	"	"	64. 9. 5
May 2 09	Isaac H Robbins	"	"	68. 8. 11
Burial # 151 Oct 17, 1925	Harriet C Robbins (51)	"	"	

Section Map No. 1 Plot C Lot 35  
Frank Hoeker Jr

Section Map No. 1 Plot C. Lot 31. 43

Date	Names	Residence	Age
Sept 20 1901	Mary J. Kinner	Port Jefferson	26 1/4
May 2 1904	Eveline J. Kinner	do	1 1/2
Sept 22 1905	Wm. L. Thomas	do	63 4/16
Dec 21 1905	Frank J. Kinner	Remond	40 5/10
Feb 10 1909	Charles P. Kinner	F. J.	69 6/10
Apr 3 1931	Annie Elizabeth Kinner (2nd wife of Charles P. Kinner)	" "	91
Jan 30 1948	Joseph B. Kinner		
Aug 31 1942	Zillah N. Kinner		

See Page 60  
Interment Book 1933 - name location of grave

Section Map 5. Plot J. Lot No. 11.  
Annie D. Wells.

March 14 1914	Mary A. Brown	Stony Brook	80 - -
July 10 1924	William E. Brown	"	89 - -
Burial # 270	Henry Wells		
" # 1552	and wife Wells		

Section Map No. 1 Plat C Lot 30.  
Amasa J. Sturtevant

Date	Names	Residence	Age.
Nov 21/57	Wm Washington Sturtevant	Port Jefferson	27 11.16
Mar 30 70	Elizabeth Charlotte	Removed from Sebauket w/ps Amasa	64.0.21
May 21 82	Charlotte	" " w/ps	32.7.21
June 23 92	Amasa	" " w/ps	86
May 25 1908	Wm Frank	Stratford Conn.	69.11.28
Oct 5 1938	Margaret	" "	

August Blumenauer.  
Section Map #7 Plat K Lot 8

Aug 1-1920	William F. J. Blumenauer	Port Lincoln	21-0-0
Mar. 12 1928	Ida B. Blumenauer	" "	54 -
Burial #196	Maude B. Blumenauer		
" # 266	August Blumenauer		

47  
30

Section Map. Charles D. Lot 18. <sup>45</sup>

Date	Names	Residence	Age
Nov 19 82	Ruth A. Dooker - dau. Chas.	E. Setauket	20 y. 27
May 9 95	Charles Dooker	"	62 1/2
May 4 - 1920	Sarah Elizabeth Dooker, wife of Chas. D. Sea Cliff	"	75 0. 18
<del>Dec 30 1964</del>	<del>Julia T. Mills lived there</del>		<del>57 yrs</del>
OK. <sup>same</sup> Apr. 28 - 1964	Julia T. Dooker Mills	Vanst. - E. Setauket	87 yrs

Carl Kapp  
Section Map #7 Plot K Lot #7

Aug 3 - 1920 Rolf Kapp East Setauket 0-6-0

18 46 Section Maps No. 1. Plat. Lot 3.

Date	Names	Residence	Age
Oct 10 1853	Thomas W. Looker	Romanes from Little Rock	36.9
Apr 9 76	Eugene D.	" son of T.W.	74.22
March 12 1903	Sarah J. Looker	wife of	56
Aug 4 1905	Charles L.	" son of T.W.	24
Jan 17 1908	Charles J. Looker	"	64-1-29
Jan 14 1923	John H. Tilly	undertaker G.B. Davis	44 -
Mar 21 1926	Genevra F. Shute	"	44 -

Section Map No. 1. Plat B. Lot 23

Elvin H. Rogers

Burial # 916 Elvin H. Rogers  
 " # 1026 Jennie S. Rogers

49  
13

24  
23

Section Map No. 3. P. 5. P. 6. Lot 47.

Date	Names	Residence	Age
Aug 26/46	John C. Smith son of Daniel S. Smith	Schaubek	29 1/4
Nov 23/46	Sylvester "	Remond "	45 1/2
Oct 31/54	Mary " wife of Sylvester "	" "	44 2/19
Aug 9/55	Harriett Udall	E "	74 0/0
Mar 22/59	Benj. B. Udall	" "	77 6/0
Feb 10/1905	Daniel S. Smith	Port Jefferson	60 7/20
May 24/1808	John Chesterfield Miller	Westhampton Beach	76 5/14
May 1/1914	Sarah E. Smith wife of Daniel		63
Nov 18/1922	Harriett E. Leask <sup>Underwriter</sup> R. S. Parr	N. Haven Conn, New Haven.	83-6-10
Mar 27/1929	Mary E. Leek	Stratford Conn	84-3-12

John M. Brown and Henry S. Wicks  
 See map no. 5. Plot 1 - Lot 67 <sup>with</sup> ~~half~~

May 17/1920 Evelyn Sophie <sup>O. B. Davis (D.C.) street 46 St. Louis</sup> Brown Port Jefferson, L.I. 75  
 Burial # 435 John M. Brown

Burial # 589 Henry Wicks south half of lot  
 " # 1182 Martha B Wicks



Section Map No. 22. State Lot 25  
Joseph L. Dickenson

Date	Names	Residence	Age.
1907	Erad. Dickenson	Port J.	06.14
1908	Alice M. " "	"	9.6.24
Sept 17 '87	Joseph L. Dickenson	"	14.1.51
Sept 25, 1901	Benjamin Franklin Reeve	Setauket	76.10.2
Dec 30 "	Hannah M. Reeve	"	86.2.2.
March 16, 1919.	Anna M. Dickenson	Port Jefferson	74
Nov. 26/37	Clindo R. Dickenson	King's Pora	56
Born 11/22/27	RAYMOND DICKENSON	NEW YORK	
" # 1556	Edith L. Elster		

See map no 24 Plot H Lot 74  
May Kamper " " 74

Nov. 23 1920	Richard Kamper	Port Jefferson N.Y.	65
Feb. 16 1924	Annice Marie Kamper	"	60
Apr. 9 1924	Edith L. Elster	"	1

I hereby give permission to my niece, Mrs James N. Downis, to use a part of my plot in Cedar Hill Cemetery for burial purposes. (Located in Port Jefferson, County of Suffolk New York)

Signed May Kamper

Dated June 21, 1935 William James Downis

48<sup>B</sup>

Section Map No. 22. *Plate* Lot 6. *2125*

Date	Names	Residence	Age
Feb 24 76	Evad. Dickenson	haut	0.6.14
Mch 8 83	Alice M.	"	9.6.24
Sept 17 87	Joseph L. Dickenson	"	14.1.51
Sept 25 1901	Benjamin Franklin Reeve	Setauket	76.10.2
Dec 30 "	Hannah M. Reeve	"	86.3.2
March 16 1919	Anna M. Dickenson	Port Jefferson	74
Nov 26/37	Alindo R. Dickenson	King's Park	56--
Burial # 1527	RAYMOND DICKENSON	111 NEW YORK	
" # 1556	Edith L. Slater		

See map no 24 Plot # Lot 74  
 May Kamper " H " 74

Nov-23 1920	Richard Kamper	Port Jefferson, N.Y.	65
Feb 16 1924	Annie Marie Kamper	" " (O.B.D. Inc. J.R. Addis)	60
Apr 9 1921	Herbert Kamper	" " (O.B.D.)	1
Burial # 135	James Deparis	J.R. Addis	
Burial # 210	May Kamper		

ROGUE, N. Y.  
 TO L. J. BARBER, M. D., DR.  
 214 EAST MAIN STREET  
 June 1, 1935  
 Mrs. Elizabeth  
 38

Section Map G. Lot 8. 49

Date	Names	Residence	Age
Aug 21 '61	Samantha Still	Pf	14.9
Aug 64	Harris J	"	25.0
Jan 13 '65	Etherine	"	1.1.0
Sept 6 '67	Sardner Still	"	41.9.0
Nov 18 '86	James Sardner " son Jack & Lizzie	"	0.9.11
Nov 13 1909	Sanne Still	"	76-6-0
Apr 20 1929	Myrtle E. Mary	"	26- -
Burial # 38	Charles Clark		

Sec map no. 4. Plot 52 H  
Mrs. Minnie Valerius

Oct. 26-1930 Ferdinand Valerius (O.B.O. Inc) J.R. Addis  
Sept. 17 1942 Ferdinand Valerius P. Jefferson Sta 5-3  
Burial # 1145 Minnie Valerius 38-41

Mrs. & Mr. James Ruff (Southside, Va.)  
Burial # 218 Annie N. Ruff  
Burial # 680 James Ruff

This was sold to Mr. & Mrs. James Ruff (Bill J. Hall)  
 June 20 1933 by Mrs. Minnie Valerius

Section Maps No. 1 Plat B. Lot 3.  
*George*

Date	Names	Residence	Age
Aug 5-88	Christina Rau,	wife Geo. P. J.	68.4.0
July 12/89	George "	Brooklyn	68
" 28/95	Phillipine Schwarz	"	50
Sept 1 80	Florence Marian Brown		16.0.16
Dec 4 81	George Bertram Schwarz		7.2.25
Nov 8/27	William Schwarz	Brooklyn	88 -
May 16/31	Edward Warren Schwarz	(Seafnd) (Mary E. Seafnd)	5-9
Sept 15/45	Luise Schwarz	Beem N. J.	67.6.2

Thomas O'Connell  
Section Map 6 Plat J Lot 30

Aug 5 <sup>7</sup>	Julia E. Brun <sup>Col</sup>	New Haven	32-0-0
--------------------	------------------------------	-----------	--------

1917